

# Mobile Surveillance Trailer

---

## Leasing Return Guide *3 or 5 Panel Model*

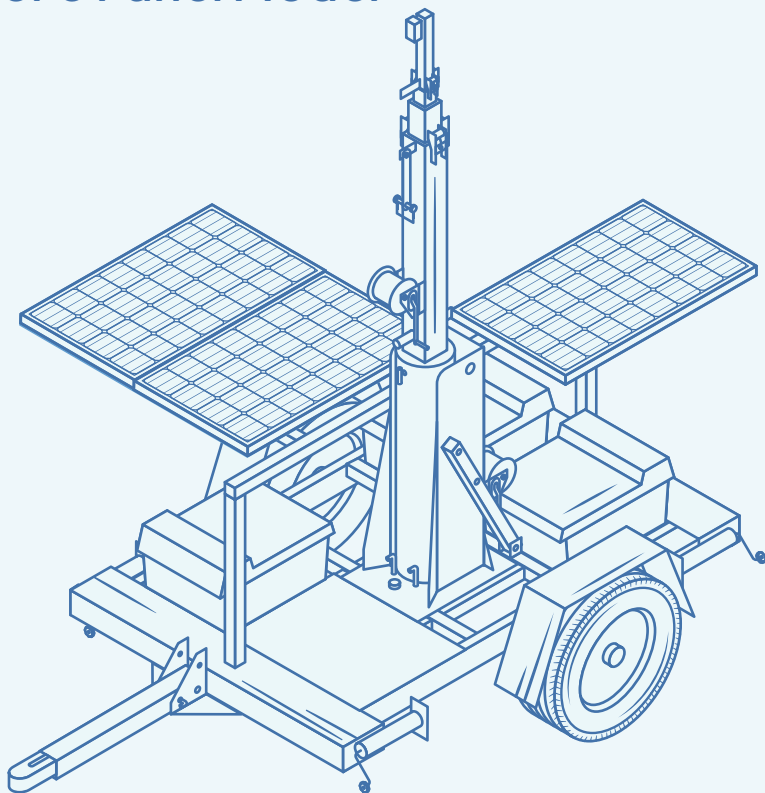

# Assembled Unit

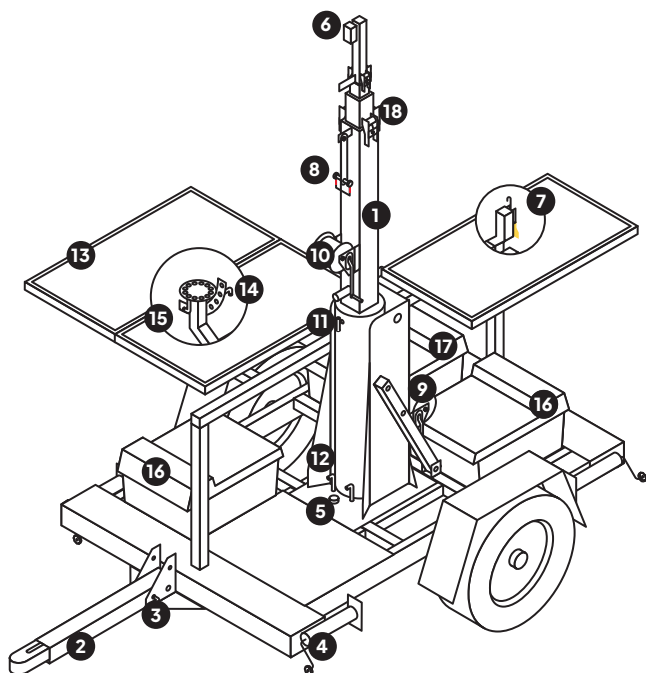

- |                        |                                |
|------------------------|--------------------------------|
| 1. Mast                | 10. Mast extending winch       |
| 2. Trailer tongue      | 11. Mast rotation lock bolt    |
| 3. Trailer tongue pin  | 12. Mast locking pins          |
| 4. Jack stands (4)     | 13. Solar panels               |
| 5. Bubble level        | 14. Panel angle adjuster bolt  |
| 6. Trailer power input | 15. Panel swivel lock bolt     |
| 7. Yellow lock handle  | 16. Battery boxes (2)          |
| 8. Red lock pin        | 17. Storage compartment        |
| 9. Mast raising winch  | 18. Mast stabilization rollers |

# Unlimited Support

---

Thank you for choosing TrueLook's Leasing Program for your jobsite's documentation needs! When your lease ends, please use the below information to contact our Leasing Department.

**Email**    [leasing@truelook.com](mailto:leasing@truelook.com)

# Trailer Return

---

This guide will walk you through how to prepare your trailer and camera for shipment. If you haven't already done so, reach out to TrueLook's Leasing Department to schedule your leased trailer's return by emailing [leasing@truelook.com](mailto:leasing@truelook.com).

# Solar Panels

**Step 1** Angle the panels to lay flat by removing the panel angle adjuster bolt and placing it in the corresponding hole.

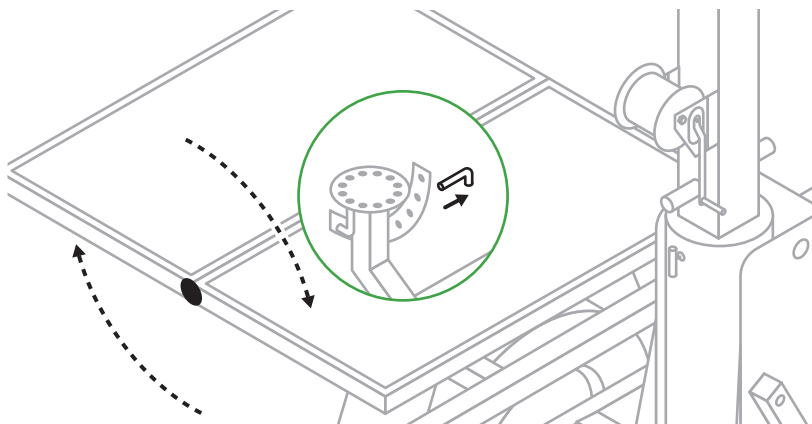

**Step 2** Rotate the panels to lie in line with the trailer by pulling down on the panel swivel lock bolt and moving the panels to lie squared with the trailer. Replace the lock bolt to secure.

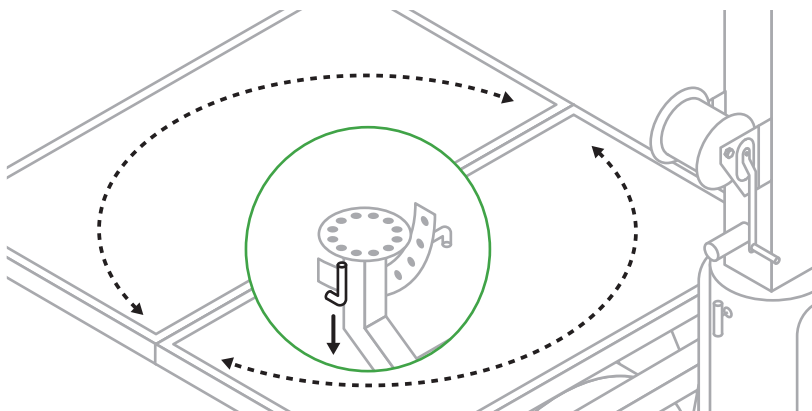

# Preparation

**Step 3** Secure the solar panels to the travel arm(s) by attaching the pin(s).

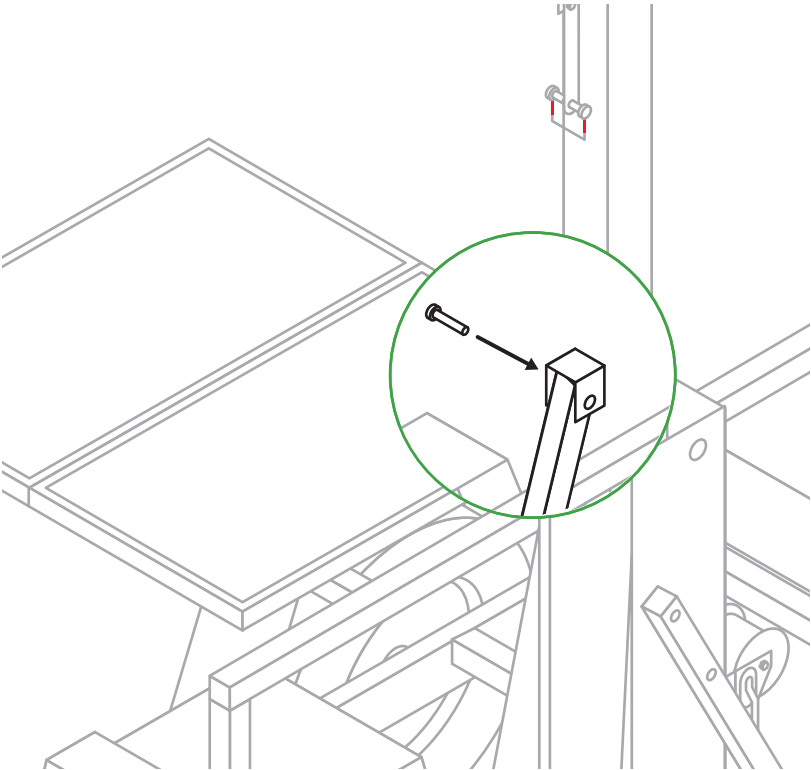

# Trailer Mast

**Step 1** Reposition the mast back to its original position by removing the rotation lock bolt and rotating the mast, aligning the red arrows to point at each other. Re-tighten the rotation lock bolt.

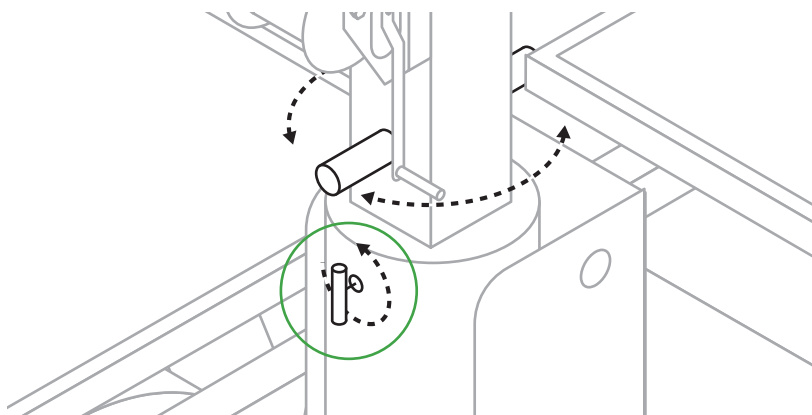

**Step 2** Use the higher winch to lower the extendable portion of the mast until fully collapsed.

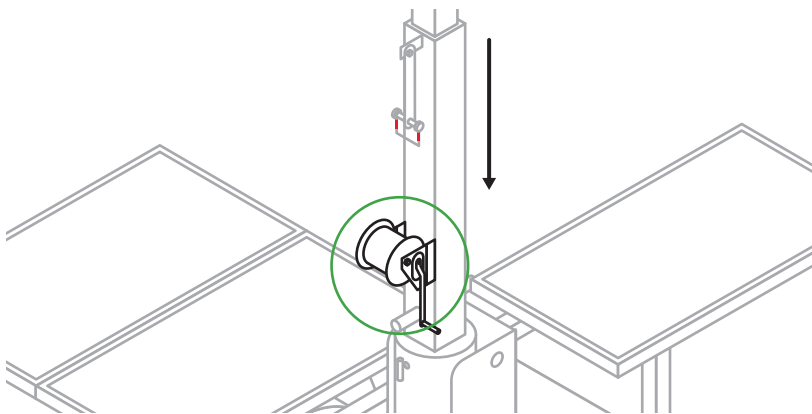

## Preparation

**Step 3** Remove the two locking pins from the holes at the base of the mast.

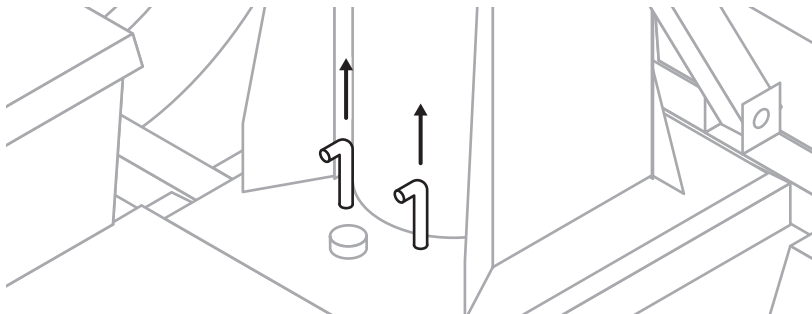

**Step 4** Use the lower winch to position the mast to lie horizontal.

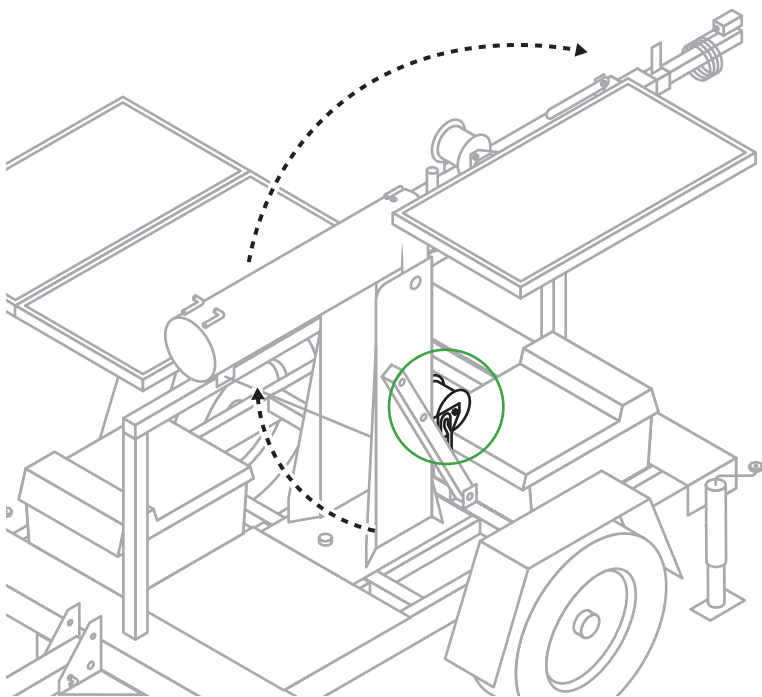

## Preparation

**Step 5** Insert the red lock pin and hook the wire to secure.

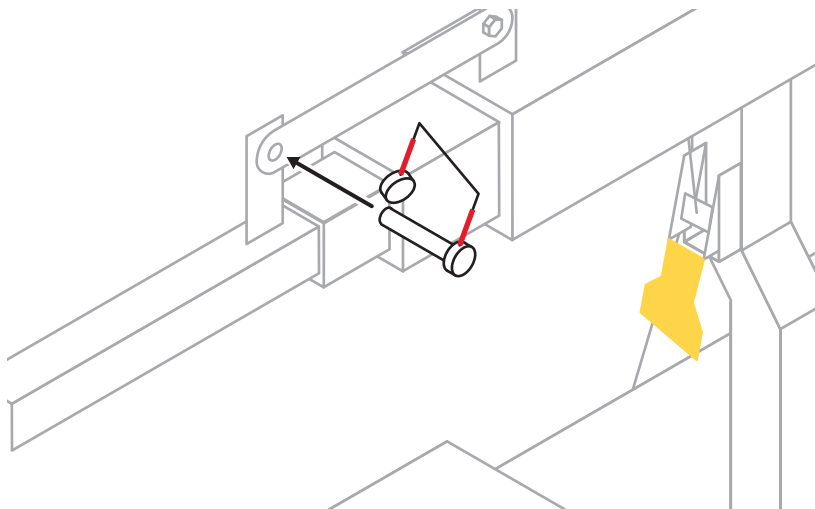

**Step 6** Lift the yellow lock handle to position the metal hook, then lower the handle to secure the hook into the hole.

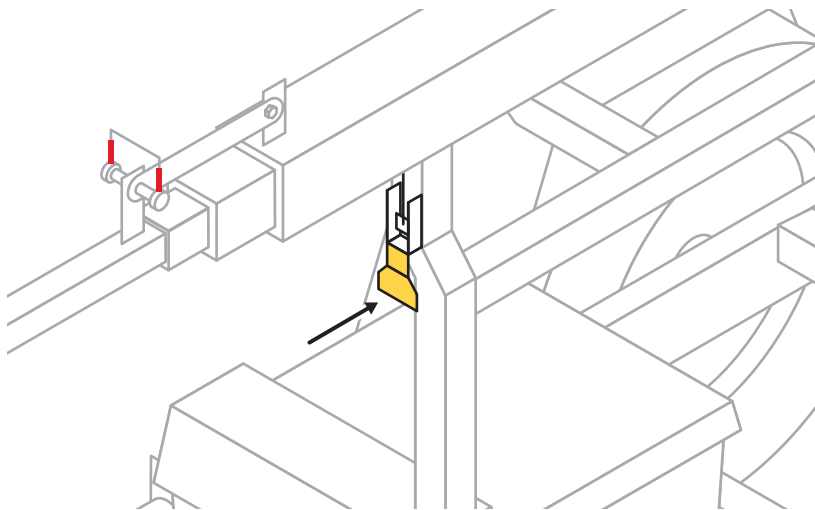



# Uninstalling System: Cameras and TrueDeter

**Notice:** Exact camera model may not be shown, and not all camera models utilize a control box. Please contact TrueLook for assistance with your camera model if needed.

**Step 1** Remove the connector with a silver collar from the camera or control box by hand-twisting the collar counter-clockwise. Repeat to remove the other end of the power cable from the trailer.

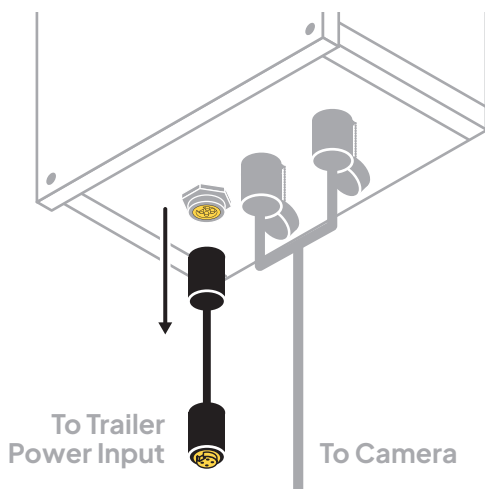

## Preparation

**Step 2** Remove the mast adapter from the mast by loosening the bolts using a 19mm wrench (not included). Carefully slide the mast adapter off the trailer mast end.

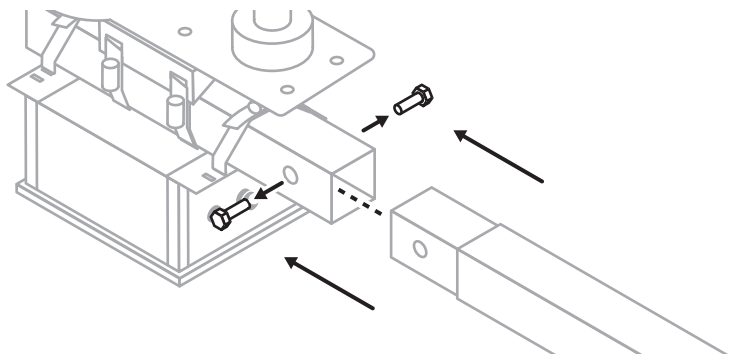

**Step 3** Thoroughly clean off all equipment using a microfiber cloth. All equipment must be completely dry before placing inside the provided shipping box (or comparable box) to prevent water damage.

**Step 4** Place the lens cap on (not applicable to PTZ cameras) and wrap the camera system in bubble wrap. Secure bubble wrap with tape.

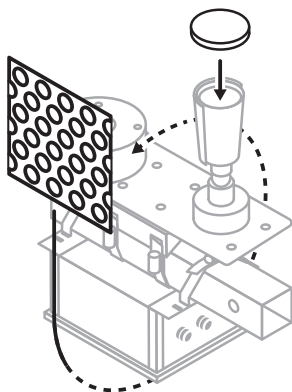

# Trailer Body

**Step 1** Put the trailer tongue down by unhooking the clip and removing the pin, then lowering the trailer tongue to be horizontal. Place the pin and hook the clip to secure.

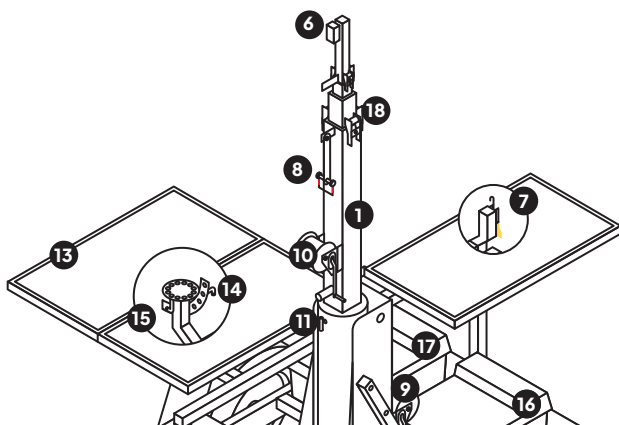

**Step 2** Put jack stands up by pulling the pin and turning the jack stands horizontal to lie in line with the trailer.

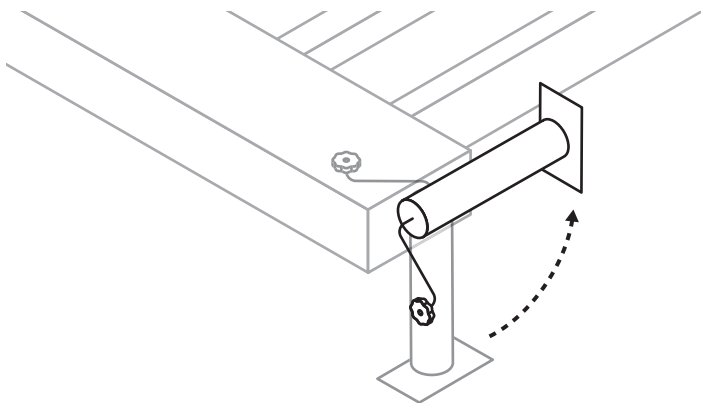

# Preparation

**Step 3** Chock all tires on both sides. Keep the tires chocked until the delivery team arrives for trailer pickup.

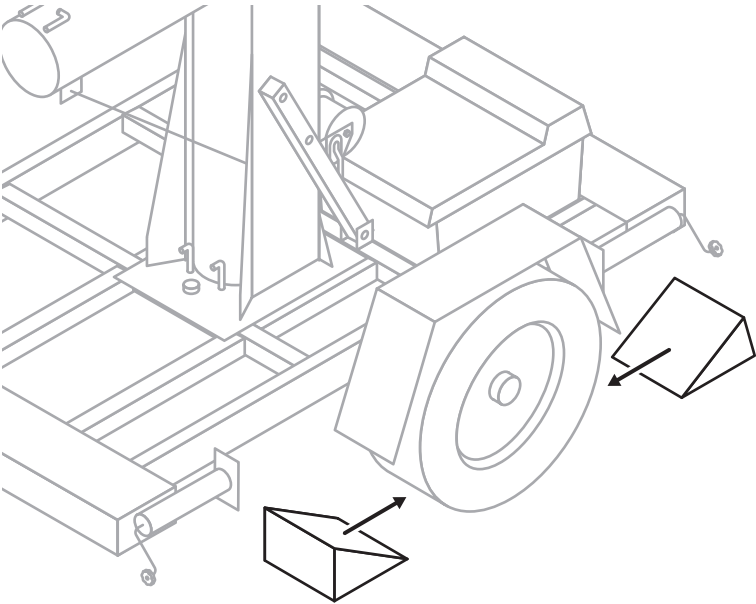

# Packing into Shipping Box: Cameras and TrueDeter

## Camera System and Control Box

Pack into the provided shipping box (or comparable box) and add extra packing material to avoid shifting.

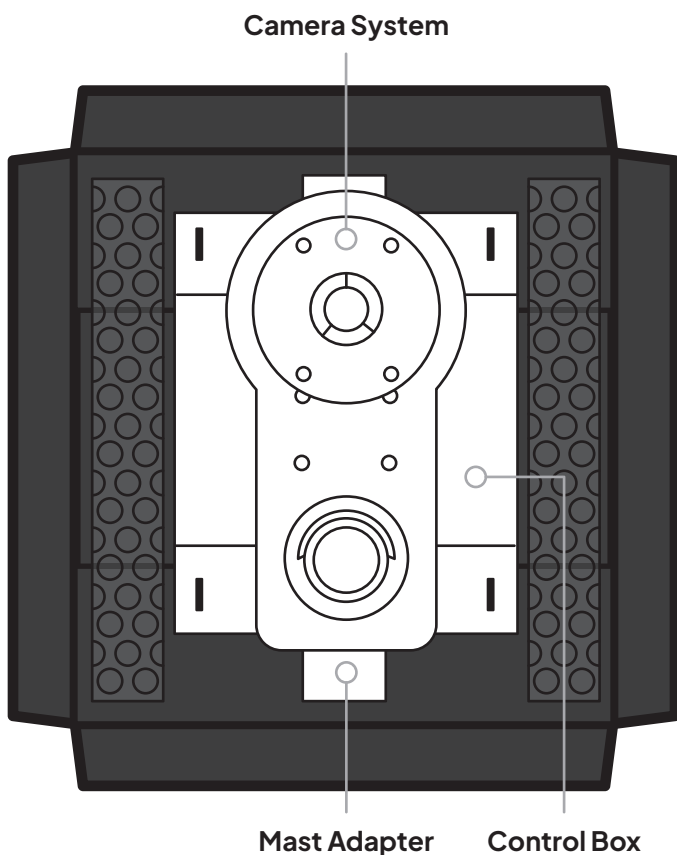

# Securing Shipping Box: Cameras and TrueDeter

**Step 1** Using the provided length of strap, measure out the necessary length for two straps to secure the shipping box to the front right of the trailer.

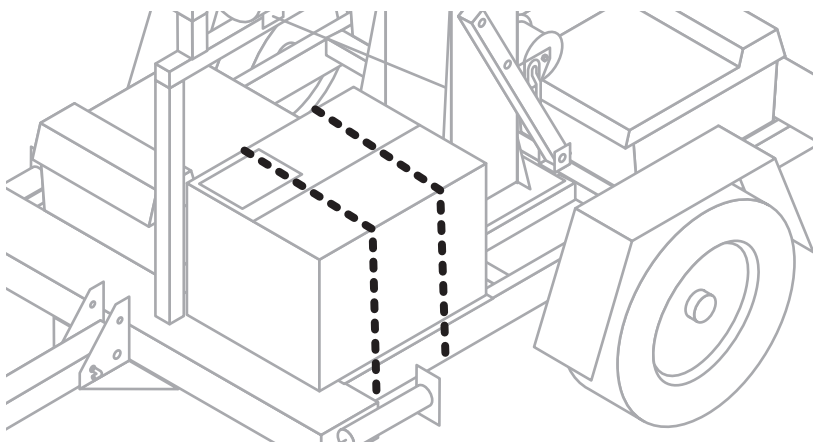

**Step 2** Cut the lengths and attach the buckles to the straps.

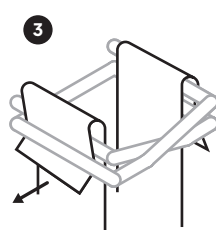
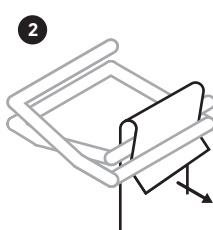
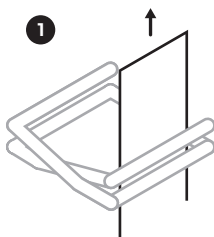

## Packing

**Step 3** Place the shipping box onto the front right of the trailer and secure it to the trailer with the straps threaded underneath the trailer body.

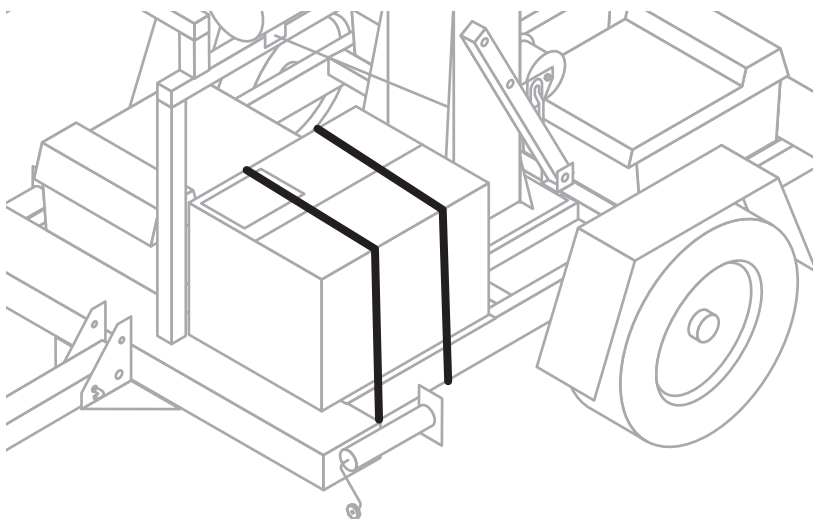

**Notice:** You may have extra unused materials. Please wrap up any unused strap length and secure it with zip ties, then pack into a battery compartment.

# Review

---

**Warning:** Please note that all equipment is your responsibility until it returns to our warehouse.

Email pictures of the trailer from all four sides to [leasing@truelook.com](mailto:leasing@truelook.com). Our team will confirm if it's ready to ship or provide suggestions for more secure shipping.