

# Mobile Camera Trailer

## Leasing Return Guide

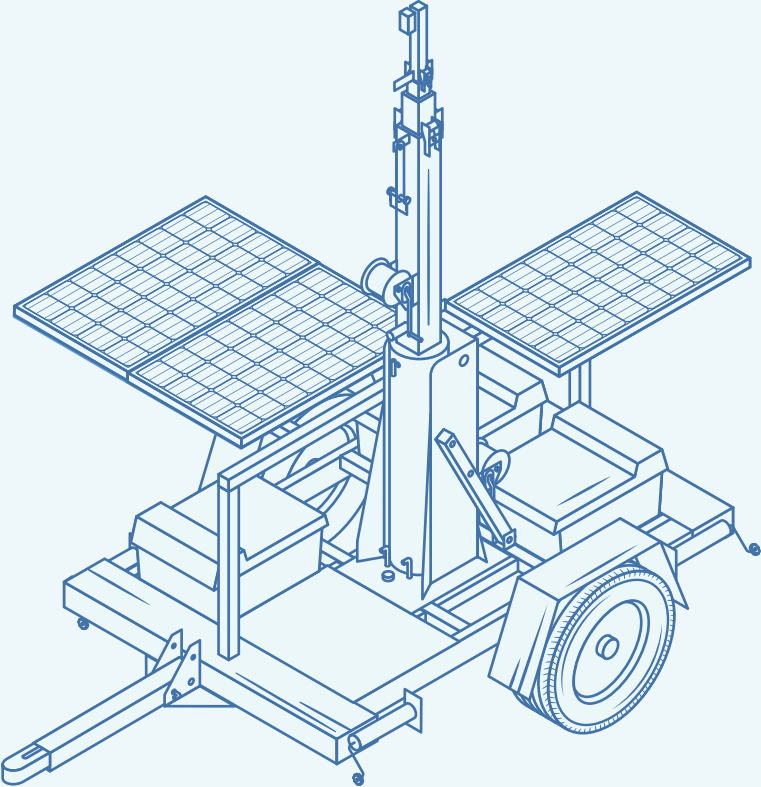

# Assembled Unit

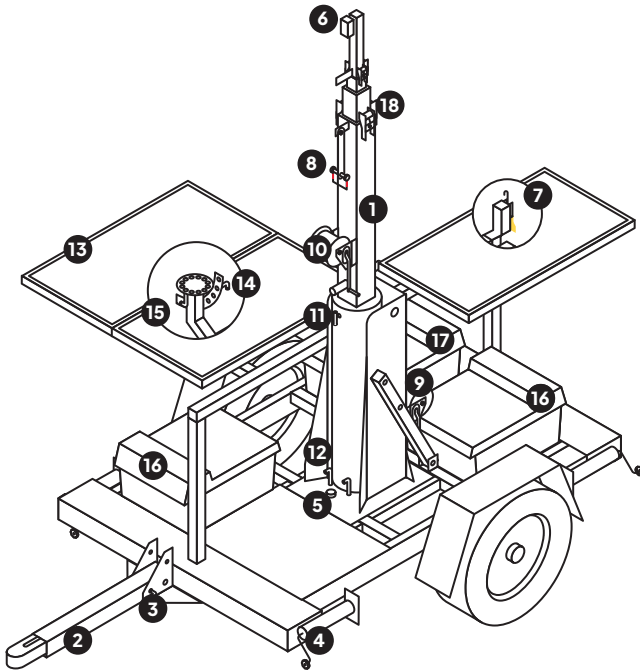

- 1. Mast
- 2. Trailer tongue
- 3. Trailer tongue pin
- 4. Jack stands (4)
- 5. Bubble level
- 6. Trailer power input
- 7. Yellow lock handle
- 8. Red lock pin
- 9. Mast raising winch
- 10. Mast extending winch
- 11. Mast rotation lock bolt
- 12. Mast locking pins
- 13. Solar panels
- 14. Panel angle adjuster bolt
- 15. Panel swivel lock bolt
- 16. Battery boxes (2)
- 17. Storage compartment
- 18. Mast stabilization rollers

# Trailer Return

---

This guide will walk you through how to prepare your trailer and camera for shipment. If you haven't already done so, reach out to TrueLook's Leasing Department to schedule your leased trailer's return by emailing [leasing@truelook.com](mailto:leasing@truelook.com).

# Unlimited Support

---

If you have any questions or issues regarding the preparation of this equipment for shipment, please don't hesitate to contact our Customer Support team.

**Email**    [support@truelook.com](mailto:support@truelook.com)

You can also submit a support request online at:  
[support.truelook.com/contact-support](https://support.truelook.com/contact-support)

# Solar Panels

**Step 1** Angle the panels to lay flat by removing the panel angle adjuster bolt and placing it in the corresponding hole.

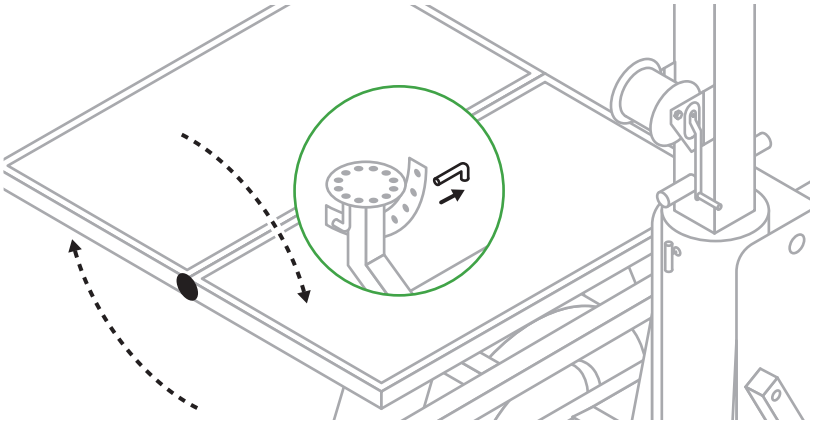

**Step 2** Rotate the panels to lie in line with the trailer by pulling down on the panel swivel lock bolt and moving the panels to lie squared with the trailer. Replace the lock bolt to secure.

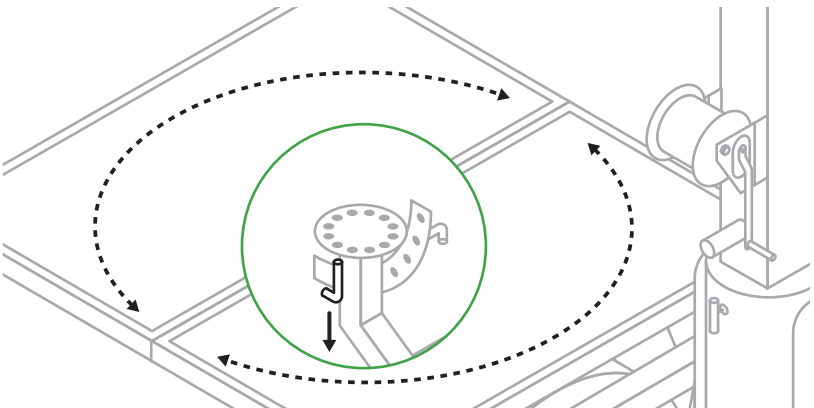

# Preparation

**Step 3** Secure the solar panels to the travel arm(s) by attaching the pin(s).

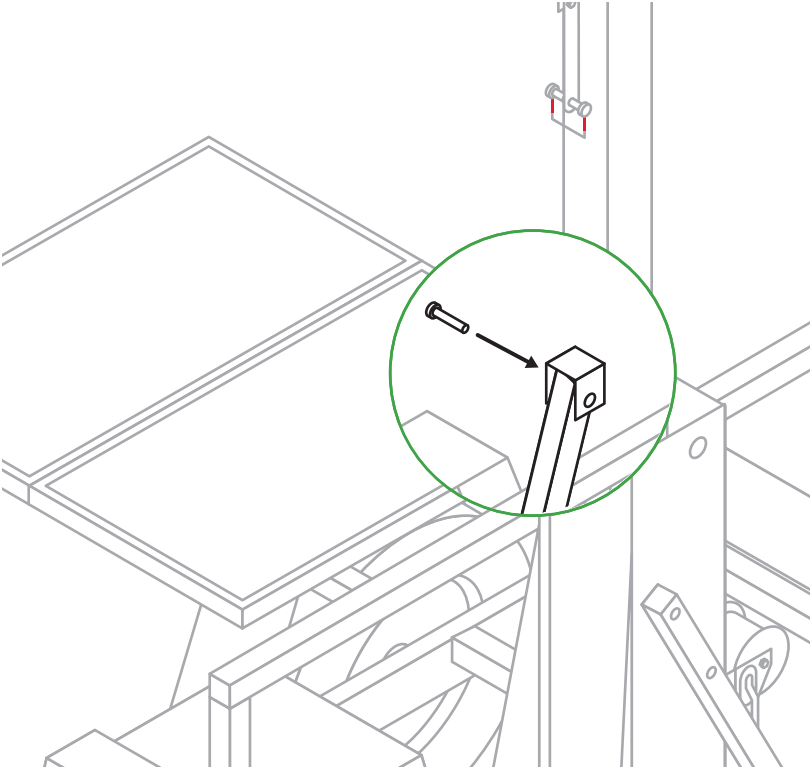

# Trailer Mast

**Step 1** Reposition the mast back to its original position by removing the rotation lock bolt and rotating the mast, aligning the red arrows to point at each other. Re-tighten the rotation lock bolt.

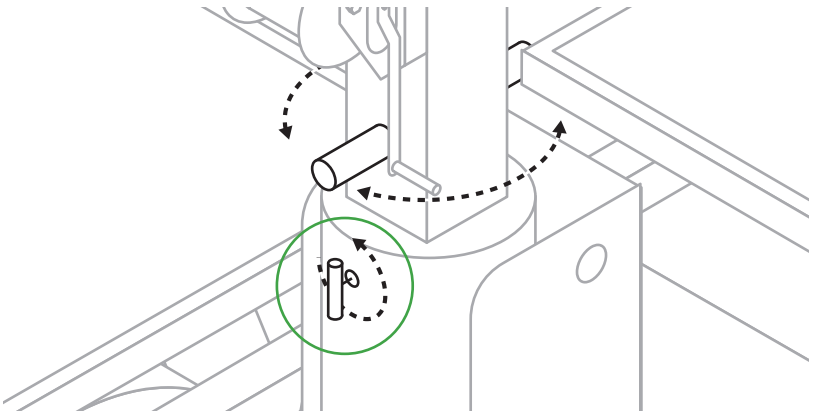

**Step 2** Use the higher winch to lower the extendable portion of the mast until fully collapsed.

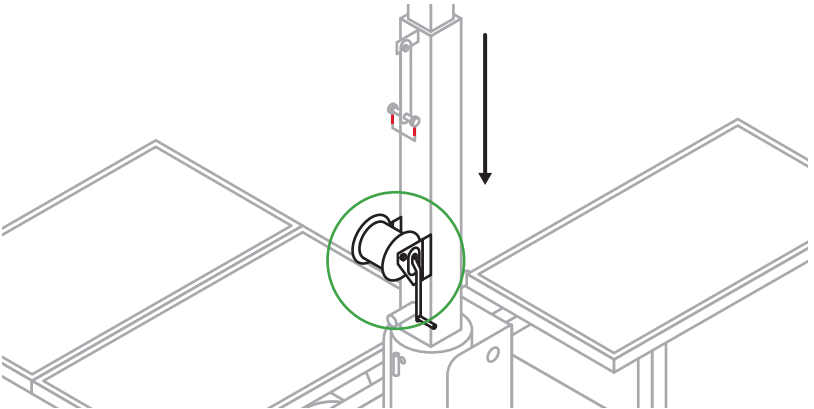

## Preparation

**Step 3** Remove the two locking pins from the holes at the base of the mast.

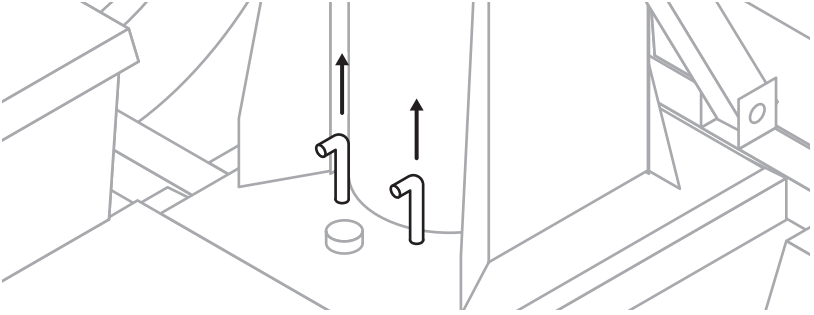

**Step 4** Use the lower winch to position the mast to lie horizontal.

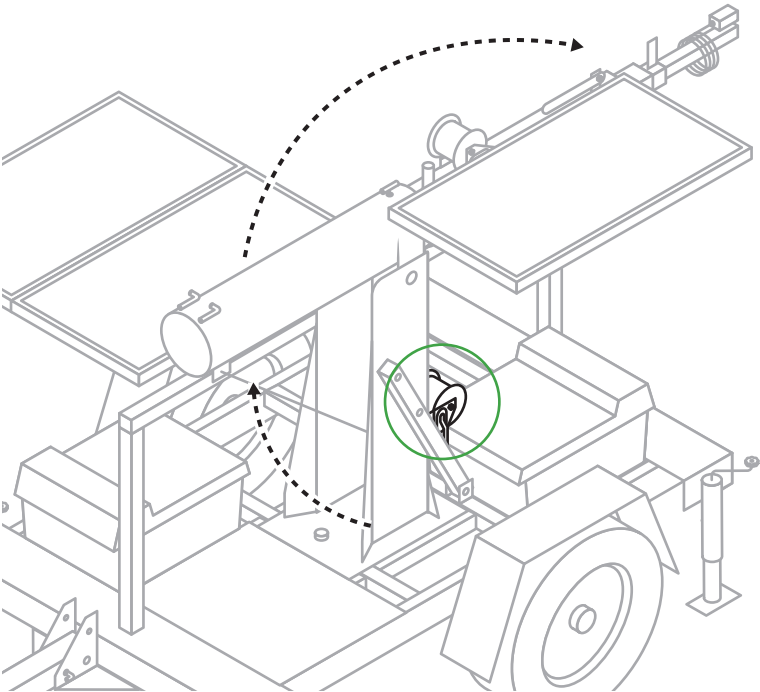

## Preparation

**Step 5** Insert the red lock pin and hook the wire to secure.

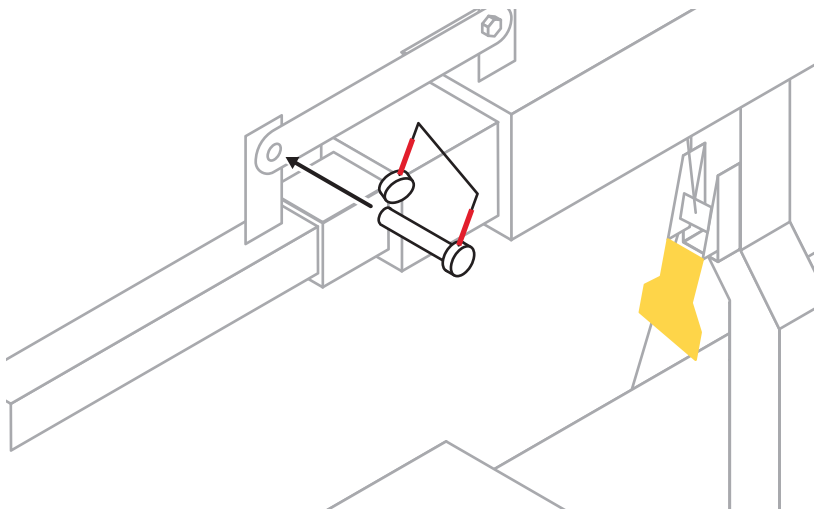

**Step 6** Lift the yellow lock handle to position the metal hook, then lower the handle to secure the hook into the hole.

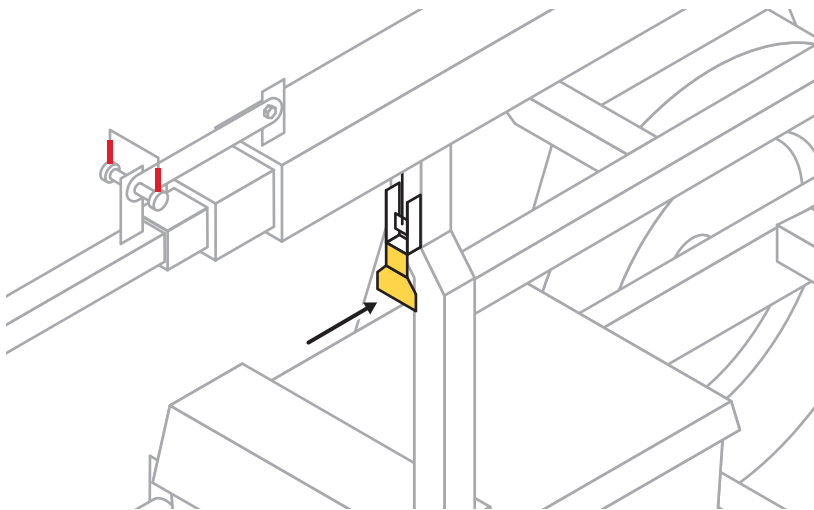



# Camera System

**Step 1** Remove the solar load connector from the trailer power input and the control box power input by gently turning the silver collar on the connector ends counter-clockwise.

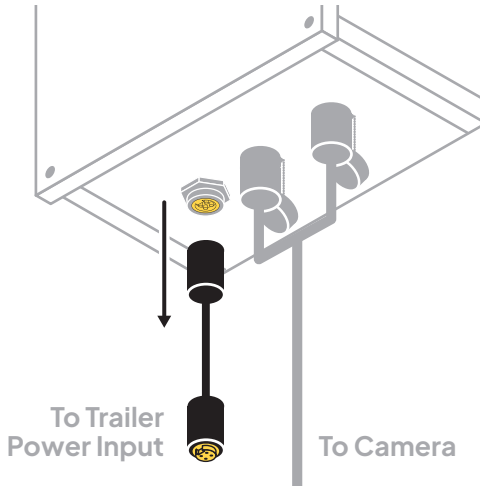

**Step 2** Remove the mast adapter from the mast by loosening the bolts using a 19mm wrench (not included). Carefully slide the mast adapter off the trailer mast end.

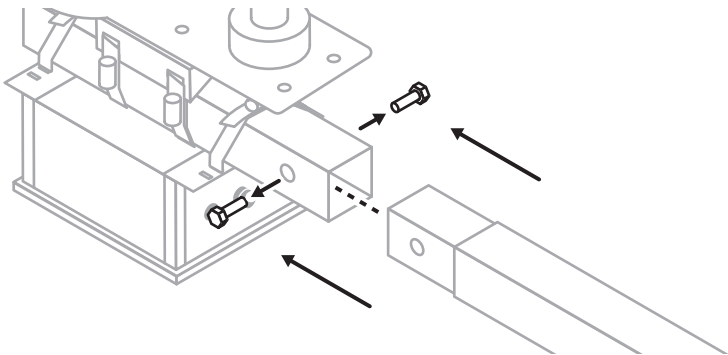

## Preparation

**Step 3** Loosen the protective plug caps on the connectors by turning counter-clockwise. Disconnect the connectors from the control box and twist the hanging caps onto the control box inputs.

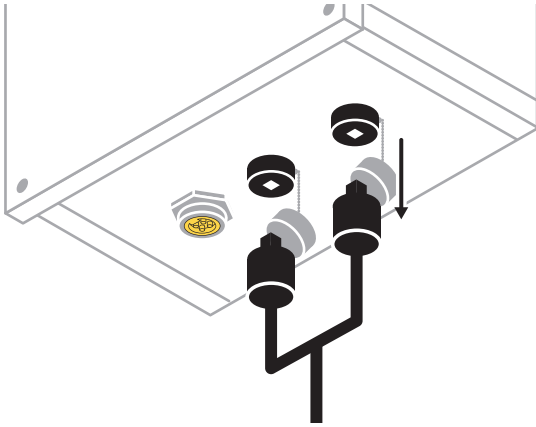

**Step 4** Remove the camera system (excluding the control box) from the mast adapter by cutting the steel straps using tin snips (not included). Safely dispose of straps, being aware of sharp edges.

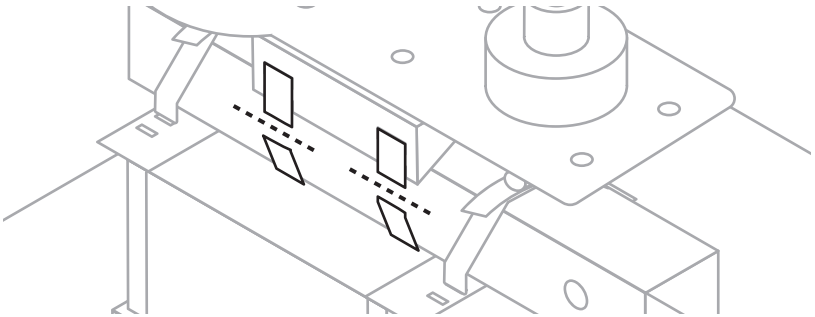

**Step 5** Using a microfiber cloth, thoroughly clean off all equipment. Ensure all equipment is completely dry before packing to prevent water damage while in transit.

## Preparation

**Step 6** Prepare the camera system for packing.

### TrueDeter PTZ

- Remove the pendant mount top by using a T30 Torx screwdriver (not included) to loosen the screw.
- Loosen the camera from the pendant housing using the same screwdriver. Remove the camera by rotating it counter-clockwise until it releases.
- Secure the pendant mount top by placing it back on and tightening the screw.
- Protect the camera from damage during shipping by covering it with bubble wrap and securing it with tape.

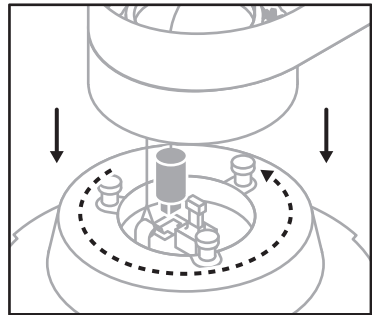
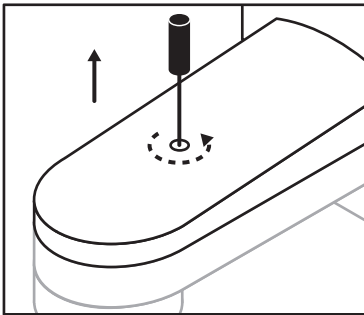

### TrueDeter Fixed

- Protect the camera lens from damage during shipping by covering it with bubble wrap and securing it with tape.

# TrueDeter Fixed

Add extra packing material to prevent damage from shifting during shipment.

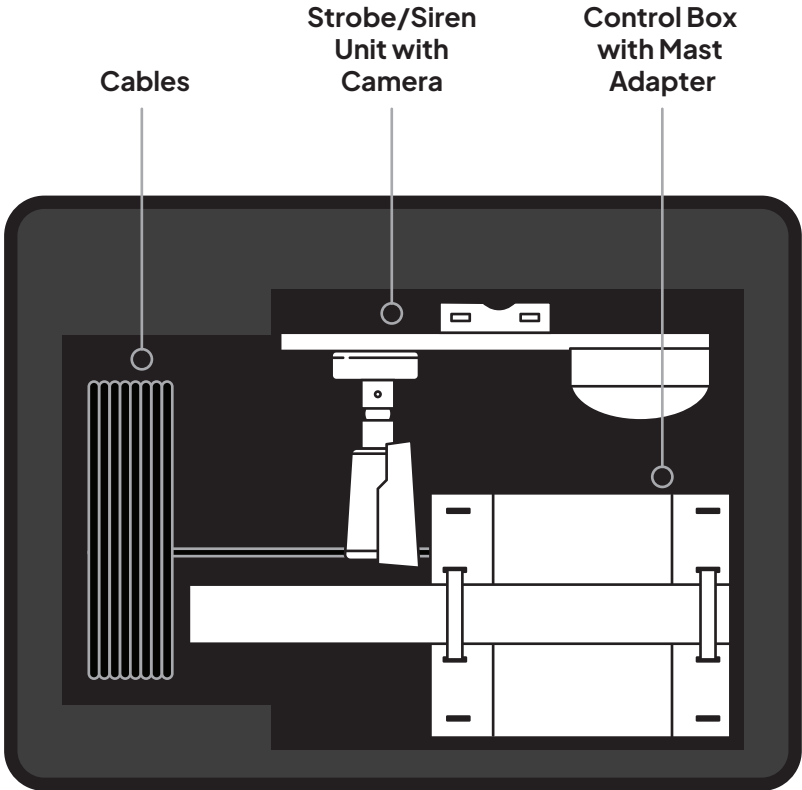

# TrueDeter PTZ

Add extra packing material to prevent damage from shifting during shipment.

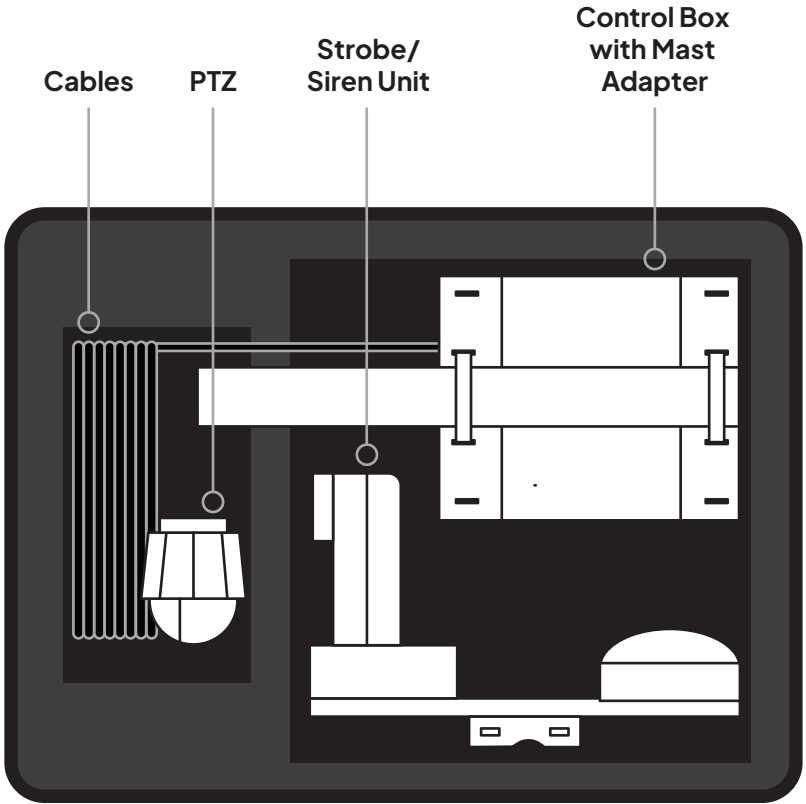

# Trailer Body

---

**Step 1** Put the trailer tongue down by unhooking the clip and removing the pin, then lowering the trailer tongue to be horizontal. Place the pin and hook the clip to secure.

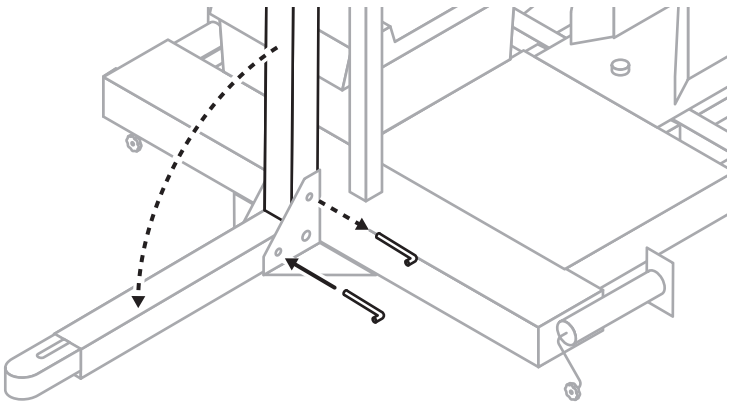

**Step 2** Put jack stands up by pulling the pin and turning the jack stands horizontal to lie in line with the trailer.

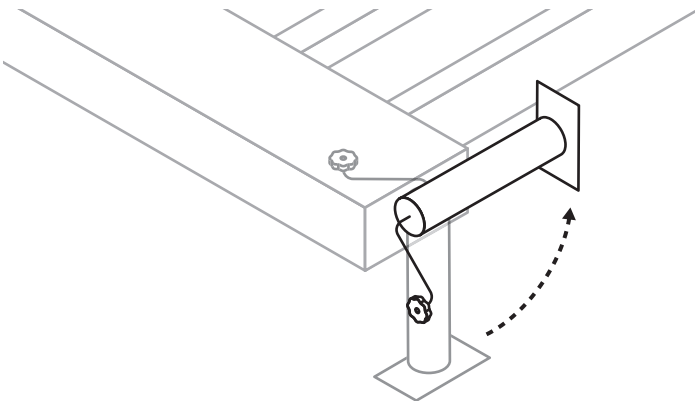

## Preparation

**Step 3** Chock all tires on both sides. Keep the tires chocked until the delivery team arrives for trailer pickup.

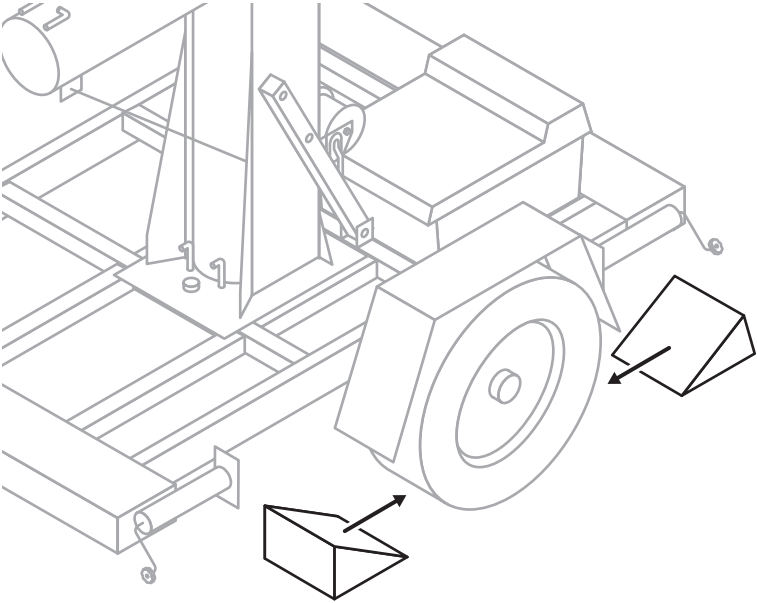

# Review

---

When the trailer is secure and ready to ship, email pictures of it to [leasing@truelook.com](mailto:leasing@truelook.com).

Our team will confirm if it's ready to ship or provide suggestions for more secure shipping.