

TrueShield Security Solution

Leasing Return Guide

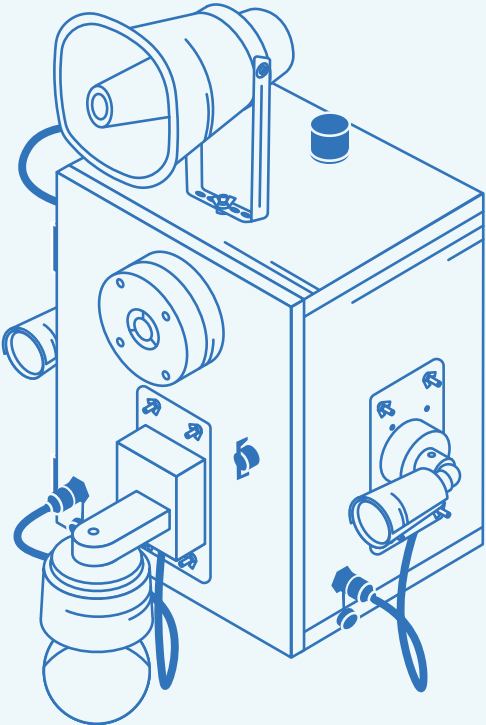

Assembled Unit

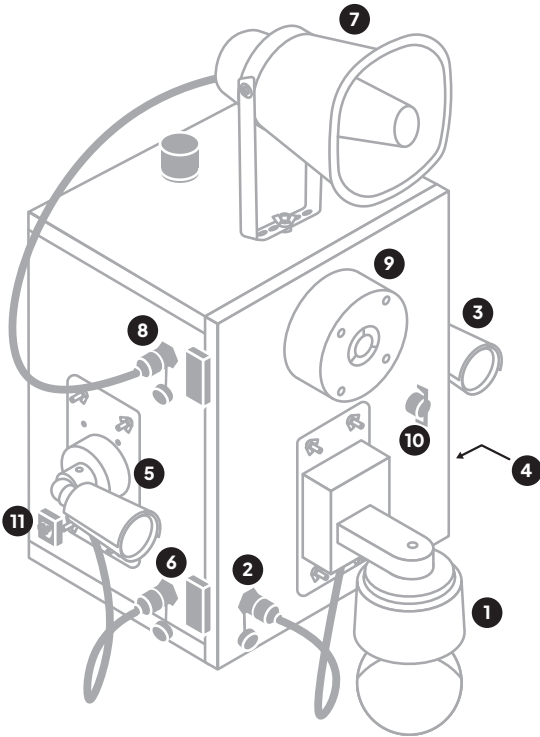

- 1. Front camera
- 2. Front camera port
- 3. Right camera
- 4. Right camera port
- 5. Left camera
- 6. Left camera port
- 7. Bullhorn
- 8. Bullhorn port
- 9. Strobe and Siren
- 10. Enclosure door lock
- 11. 110V power input

Uninstalling Equipment

Step 1 Disconnect the unit from its primary power source.

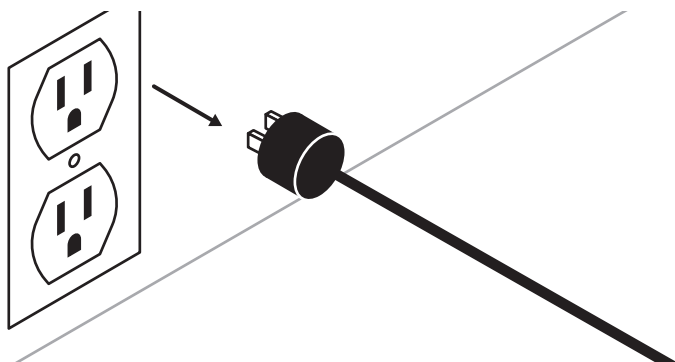

Step 2 Open the enclosure and disconnect the red and black battery connectors.

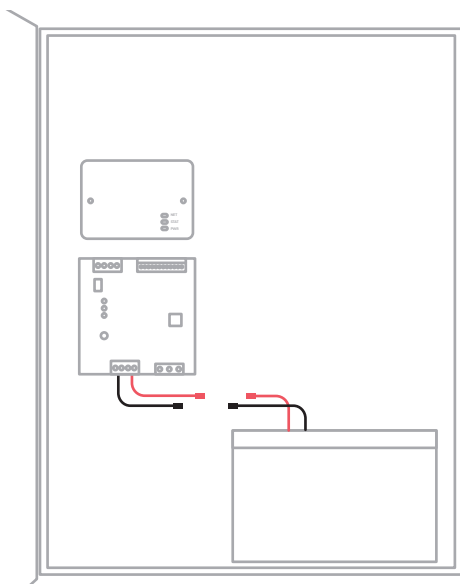

Preparation

Step 3 Separate the lower mounting bracket from the enclosure by removing the nuts on the back of the enclosure. Store the nuts in the provided plastic bag.

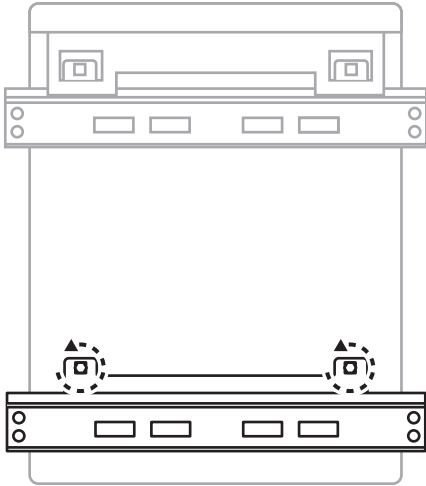

Step 4 Carefully remove your TrueLook security solution from the upper mounting bracket by lifting upward. Set unit aside.

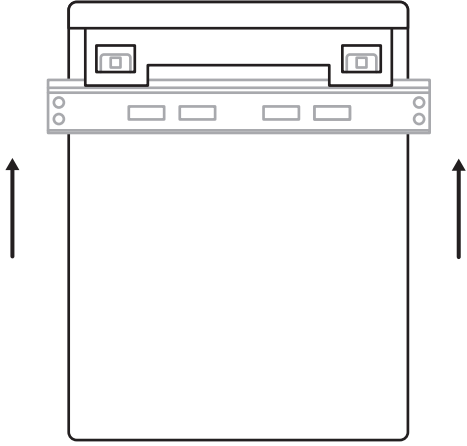

Preparation

Step 5 Uninstall the upper and lower mounting brackets from the pole or wall.

Wall Mounting

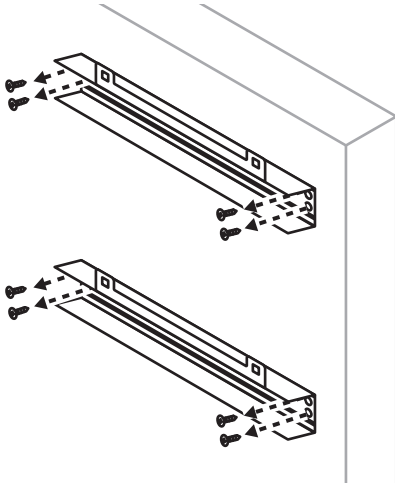

Pole Mounting

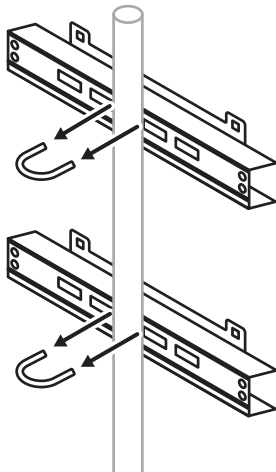

Disassembling the Unit

Step 1 Disconnect the horn and cameras from the unit by unscrewing the protective caps on the end of the connectors and unplugging the connectors.

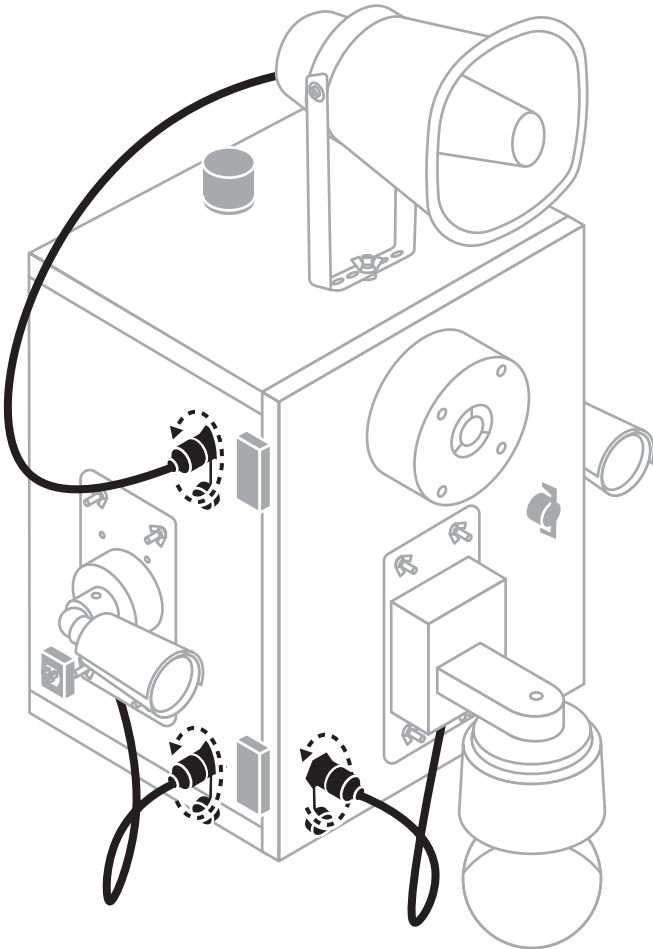

Preparation

Step 2 Screw the protective caps that are hanging from the enclosure onto each input.

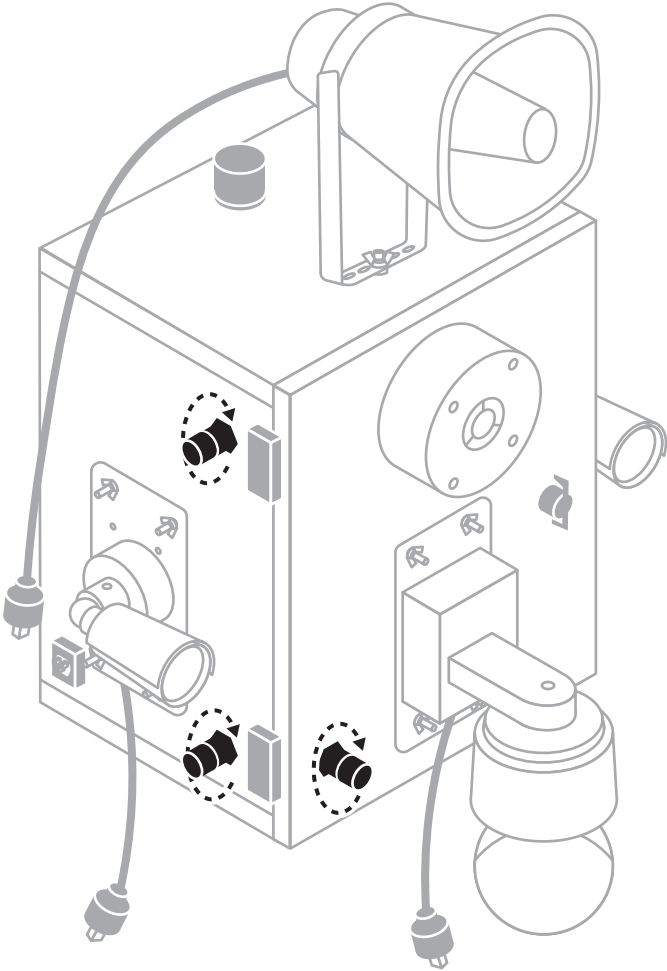

Preparation

Step 3 Remove the horn and cameras from the unit by loosening the wing nuts off the mounting studs. Store the wing nuts in the provided plastic bag

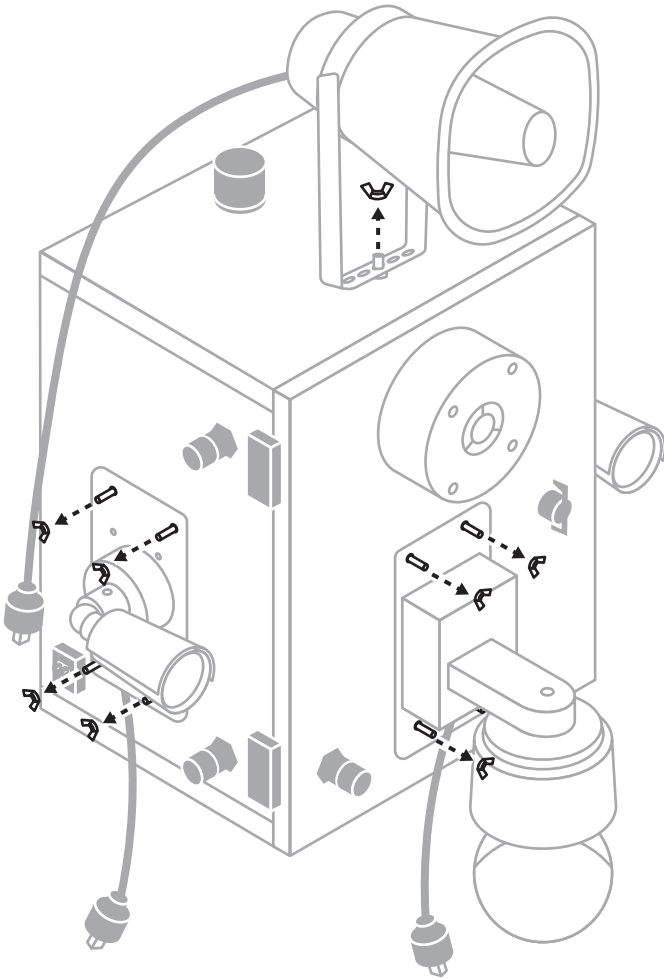

Preparation

Step 4 Using a microfiber cloth, dry off all equipment thoroughly to avoid water damage while in transit. Ensure all equipment is completely dry before placing inside the hard case.

Step 5 Place the lens caps onto the Fixed 4K IR cameras.

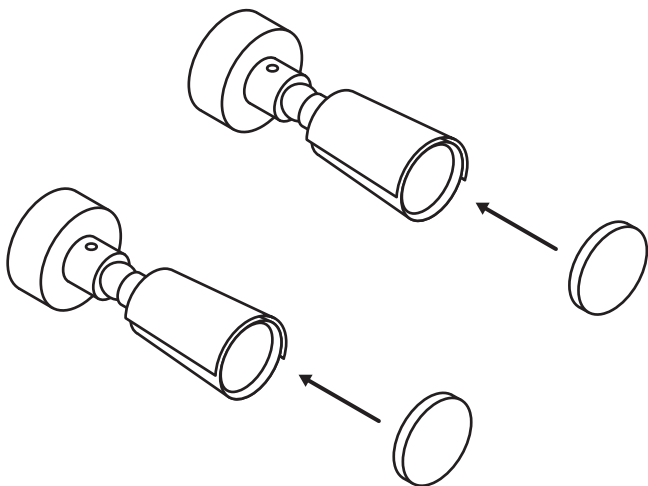

Packing into Hard Cases

Enclosure

Place mounting brackets into the hard case first. Then, carefully put the enclosure on top of them with the siren facing upward.

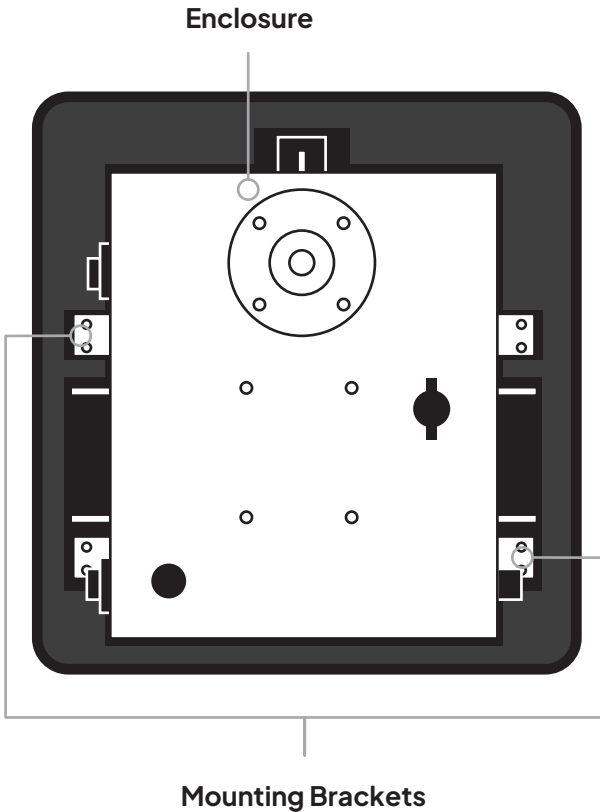

Cameras and Accessories

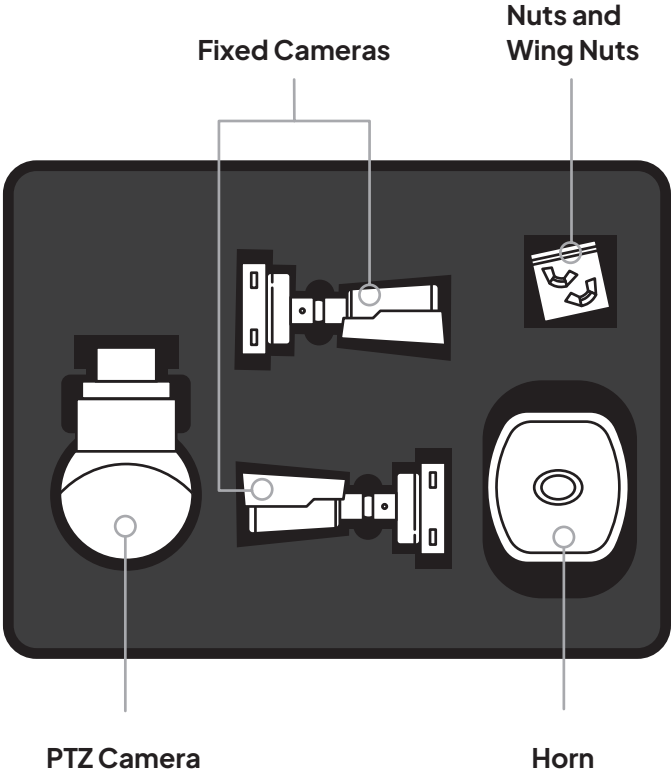

Shipping the Equipment

Warning: Please note that all equipment is your responsibility until it returns to our warehouse.

Step 1 Email a picture of the open packed cases to leasing@truelook.com. Our team will confirm if they're ready to ship or provide suggestions for more secure shipping.

Step 2 Once the cases are approved to ship, close the hard cases and ensure all latches are properly shut.

Step 3 Place your shipping labels into luggage tags (not included) and attach them to the hard case handles.

They should be shipped to:

TrueLook, Inc.
Attn: Leasing Department
305 Junia Ave
Winston-Salem, NC 27127

Step 3 Email the shipment tracking number(s) to leasing@truelook.com.

For assistance on how to safely return your equipment, email leasing@truelook.com or call 833-878-3566, option 2.