

Mobile Camera Trailer

1080p IR PTZ with Strobes and Sirens
Installation Manual



24/7 Support

Your purchase of this TrueLook system includes customer and technical support. If you have any questions regarding the use or configuration of this equipment and software, please don't hesitate to contact us.

Phone 833.878.3566

Email support@truelook.com

Office 575 4th Street E, Winston Salem, NC 27101

Online Resources

Use this QR code or visit truelook.com/install to access:

- 1 An admin guide to walk you through creating your time-lapses and other administrative settings.
- 2 Video demonstrations of installation procedures.
- 3 A digital PDF of this install guide.
- 4 Download links for the TrueLook mobile app.
- 5 Other helpful resources.



For Terms & Conditions as well as Warranty information, visit truelook.com/terms-conditions.

Hardware Packing List

**1080p IR PTZ Camera
with Strobes and Sirens**

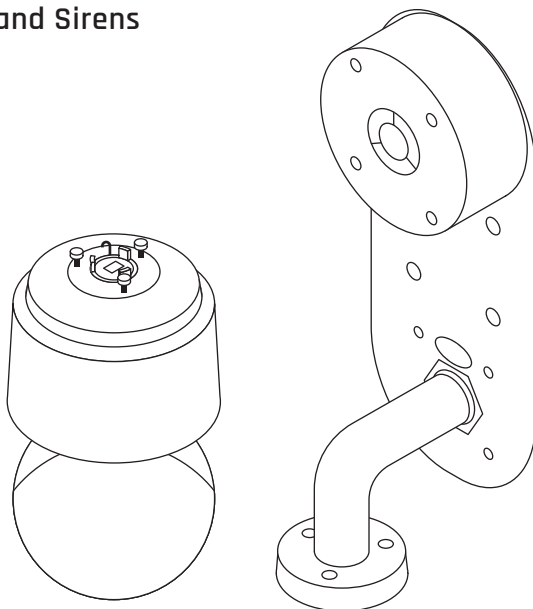

GETTING STARTED

Control Box

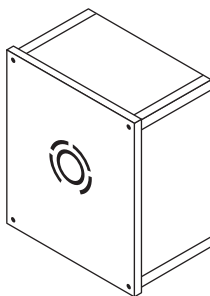

Solar Load Cable



Mast Mounting Hardware

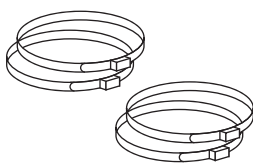

Steel Straps
(2 sets)

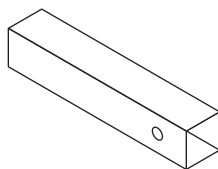

Mast
Adapter

Mobile Trailer Parts

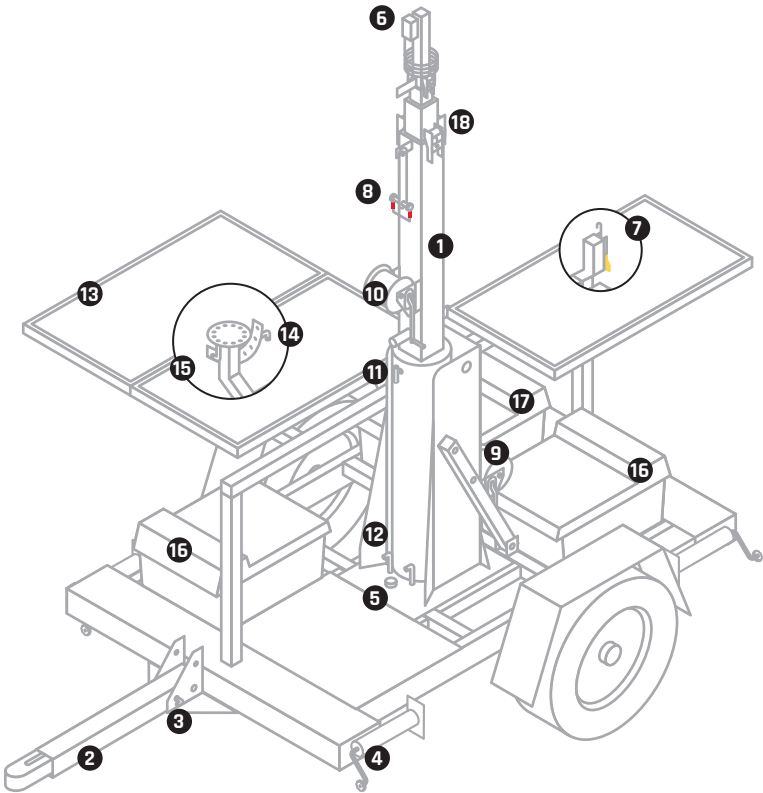

- | | |
|------------------------|--------------------------------|
| 1. Mast | 10. Mast Extending Winch |
| 2. Trailer Tongue | 11. Mast Rotation Lock Bolt |
| 3. Trailer Tongue Pin | 12. Mast Locking Pins |
| 4. Jack Stands (4) | 13. Solar Panels |
| 5. Bubble Level | 14. Panel Angle Adjuster Bolt |
| 6. Trailer Power Input | 15. Panel Swivel Lock Bolt |
| 7. Yellow Lock Handle | 16. Battery Boxes (2) |
| 8. Red Lock Pin | 17. Storage Compartment |
| 9. Mast Raising Winch | 18. Mast Stabilization Rollers |

Trailer Positioning



Place your camera trailer 20–150 feet away.

For optimal viewing, place your trailer 20–150 feet away from the area of your jobsite that you wish to capture. The distance you choose will depend on the camera you've selected (PTZ or fixed-position), the size of your jobsite, and the amount of detail you want to see.



For PTZ cameras, ensure the optimal mast location.

PTZ cameras have 360° views, but the trailer's mast will cause a small blind spot. Orient your trailer so that the mast doesn't block important areas of your jobsite from view.

Contact **TrueLook Support** with any questions.

Stabilizing the Trailer

STEP 1

Chock wheels on both sides of each wheel, then detach from your tow vehicle.

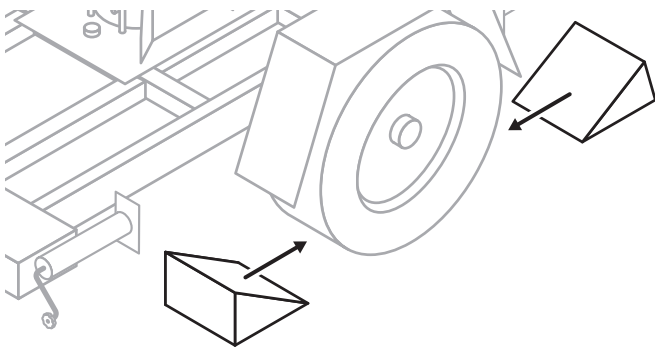

STEP 2

Lower and extend jack stands by pulling pin and turning jack stands vertical.

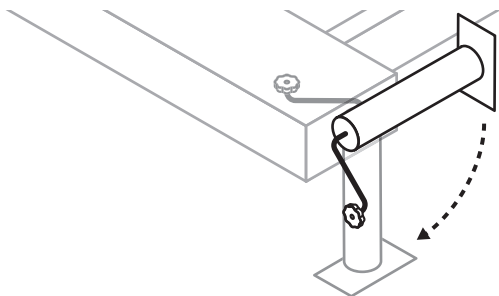

GETTING STARTED

STEP 3

Check that trailer is level using built-in bubble level.

Adjust jack stands as needed by turning handle clockwise to lower and counterclockwise to raise.

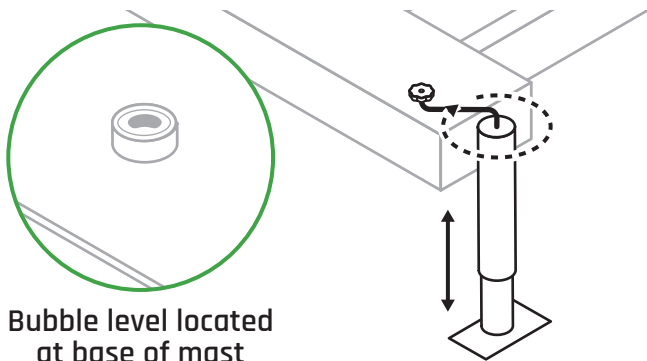

STEP 4

To raise trailer tongue for storage, unhook clip and remove pin. Raise trailer tongue to stand upright, then place pin and hook clip to secure.

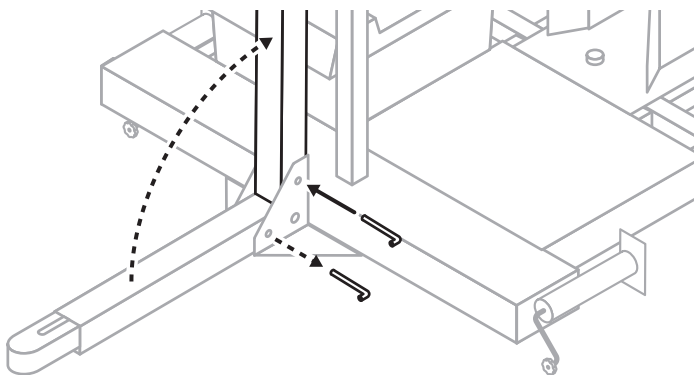

1080p IR PTZ with Strobes and Sirens

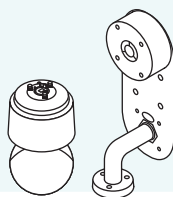

THIS EQUIPMENT CONTAINS FLASHING LIGHTS, WHICH MAY INDUCE EPILEPTIC SEIZURES IN AT-RISK INDIVIDUALS.

Control Box

STEP 1

Thread steel straps through top and bottom of mounting hardware on control box.

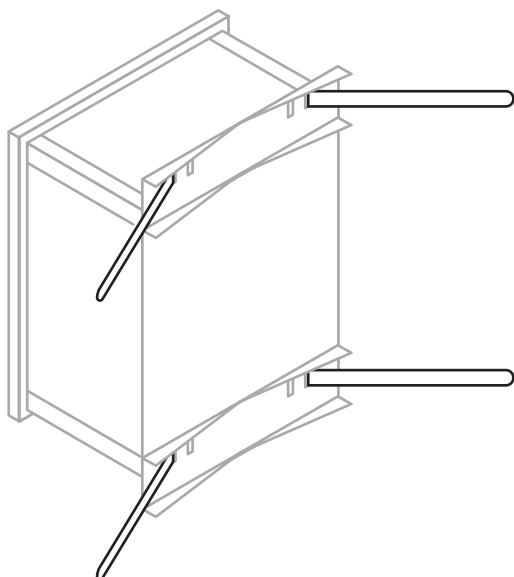

CAMERA INSTALLATION

STEP 2

Align mounting hardware to sit against flat edge of mast adapter.

Ensure connection points on bottom of control box will face downward once mounted.

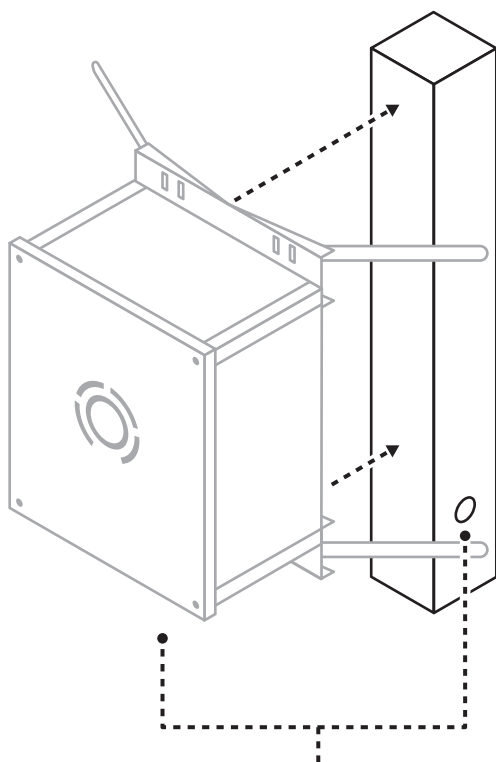

Connection points and cords should be near bolt holes on mast adapter

CAMERA INSTALLATION

STEP 3

Tighten steel straps securely using a drill with size 5/16 Hex driver bit (not included).

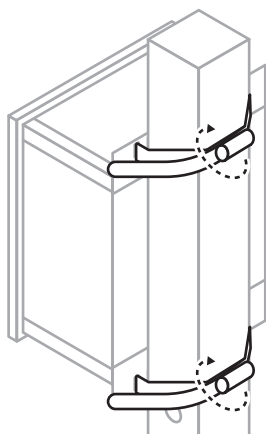

STEP 4

Trim steel straps to desired length using tin snips (not included).

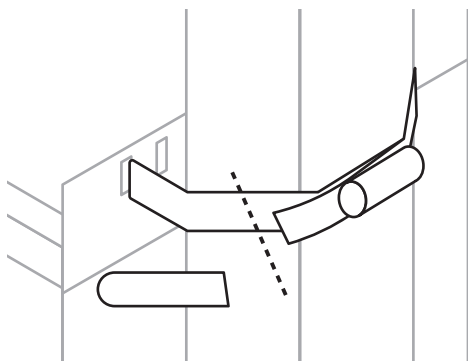

CAMERA INSTALLATION

Camera

STEP 1

Flip mast adapter with control box attached so control box is facing down.

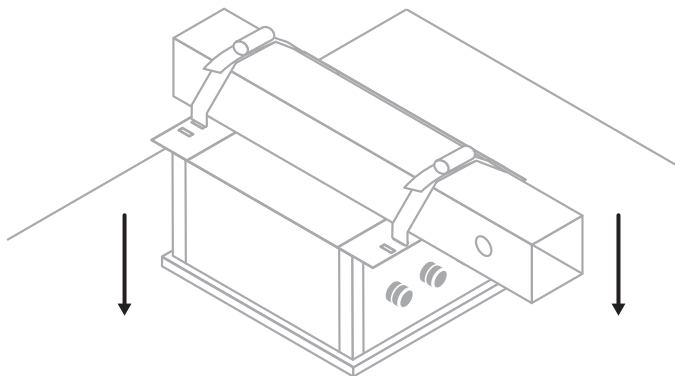

STEP 2

Thread steel straps through top and bottom of mounting bracket on back of steel plate.

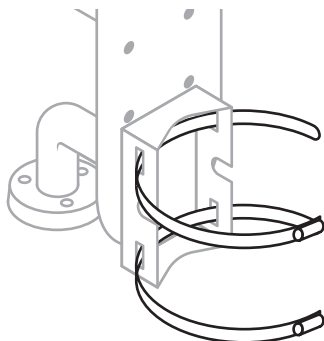

CAMERA INSTALLATION

STEP 3

Tighten steel straps securely using a drill with 5/16 hex head driver bit (not included).

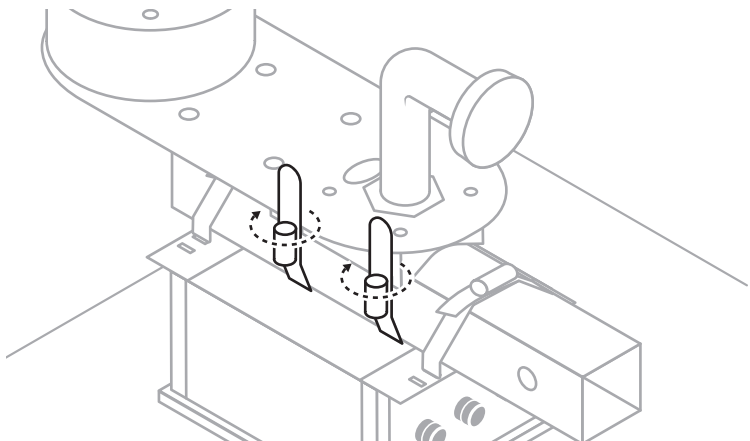

STEP 4

Trim steel straps to desired length using tin snips (not included).

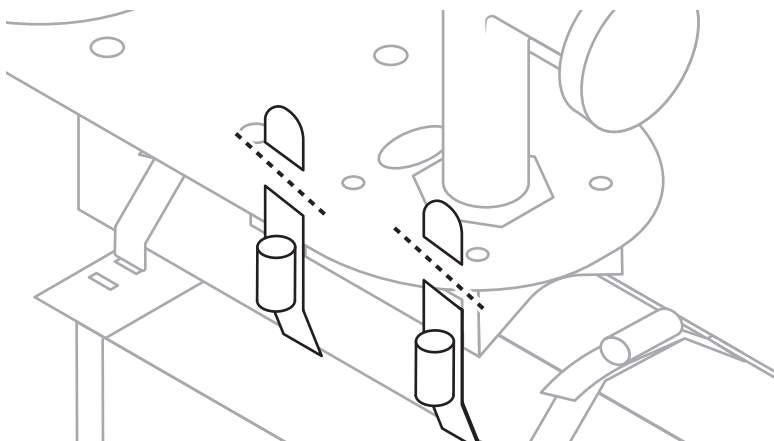

CAMERA INSTALLATION

STEP 5

Slide mast adapter with strobes and siren plate and control box installed onto trailer mast end.

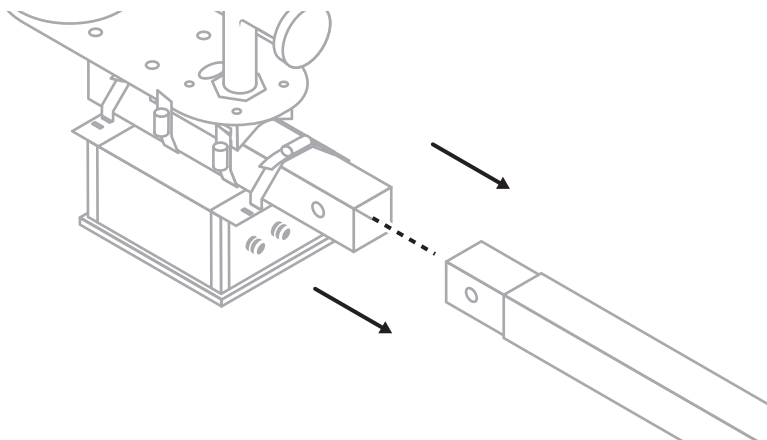

STEP 6

Secure mast adapter to mast with two bolts using a 19mm socket wrench (not included).

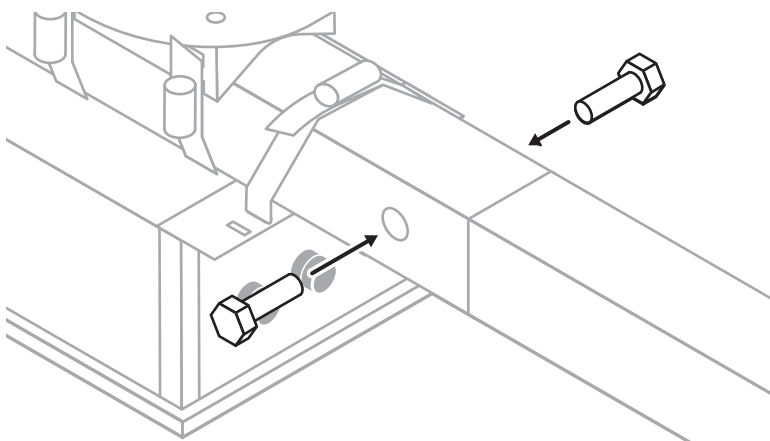

CAMERA INSTALLATION

STEP 7

Attach safety tether hanging from camera pendant to hook on top of camera.

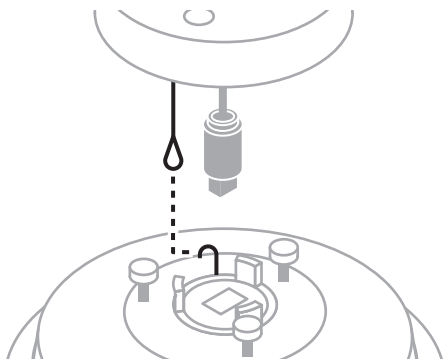

STEP 8

Plug connector hanging from camera pendant into top of camera. Connector should snap firmly into place.

Turn yellow locking ring clockwise to secure cable.

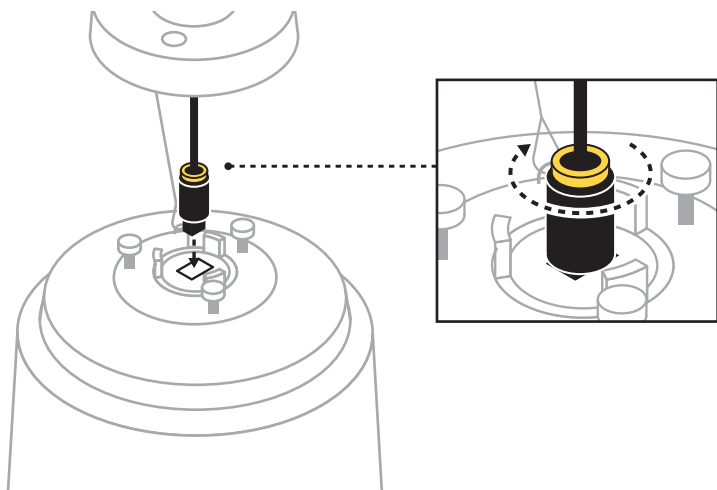

CAMERA INSTALLATION

STEP 9

Push camera up into pendant housing and rotate a quarter turn until it snaps into place, aligning with screw holes.

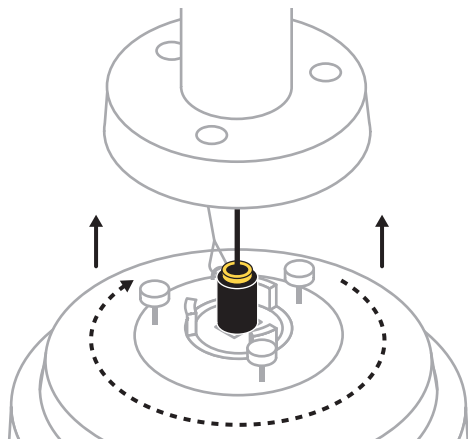

STEP 10

Secure camera to pendant housing using T30 Torx screwdriver (not included).

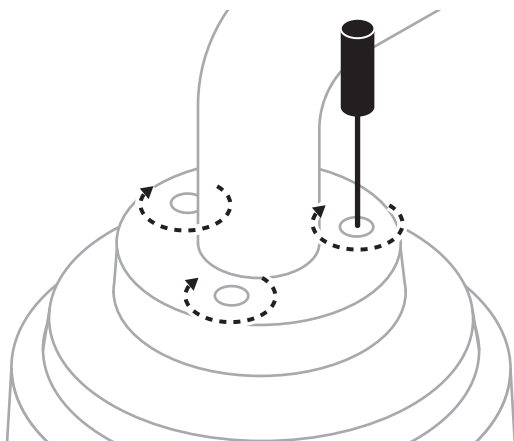

Powering

STEP 1

Twist protective plug caps off bottom of control box. Caps should hang freely.

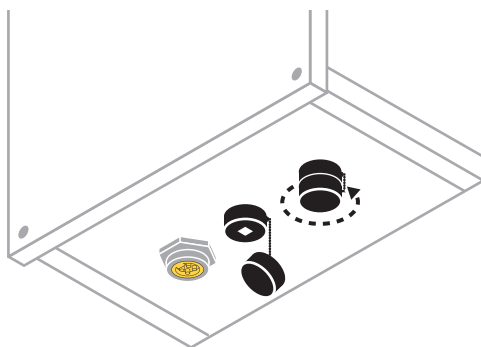

STEP 2

Connect camera and siren to control box by plugging in both connectors of braided cable coming from camera.

Connectors go into either socket and should snap firmly in place.

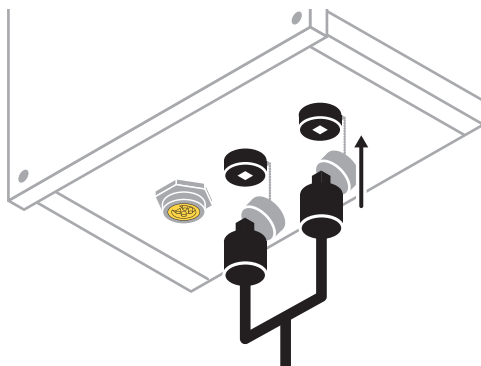

CAMERA INSTALLATION

STEP 3

Twist protective plug caps on connectors up into bottom of control box. This will create a watertight seal.

STEP 4

Provide power by aligning notches and plugging one end of solar load connector into control box power input.

Repeat with other end of solar load connector and trailer power input located on mast. Gently hand tighten to screw connectors into inputs.

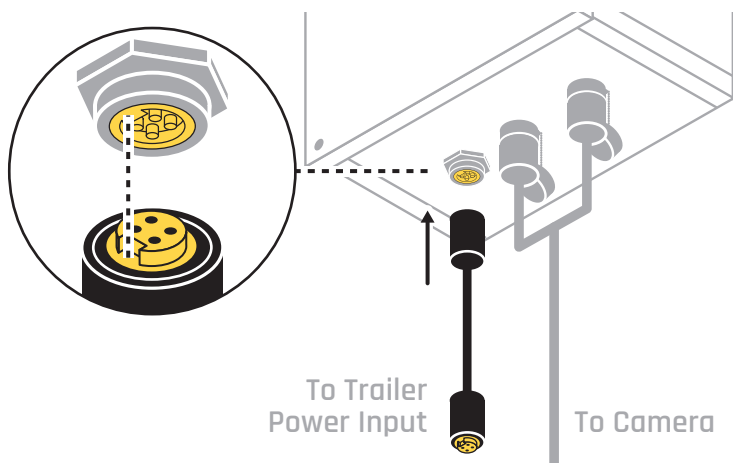

NEVER USE TOOLS TO TIGHTEN CONNECTORS. THIS MAY RESULT IN OVER TIGHTENING AND COULD BREAK CONNECTOR.

STEP 5

Remove protective covering from camera lens. Your camera will be online and ready to use within 10 minutes.

Raising the Mast



CHECK FOR OVERHEAD OBSTRUCTIONS BEFORE RAISING MAST. DO NOT STAND BENEATH MAST WHEN RAISING OR LOWERING.

STEP 1

Release yellow lock handle by pulling handle toward yourself.

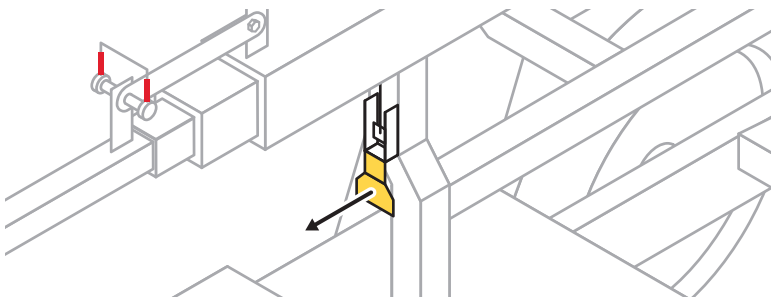

STEP 2

Release red lock pin by unhooking wire and removing pin.

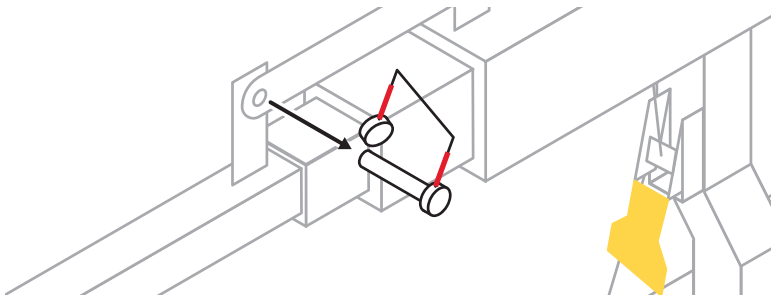

FINAL SETUP

STEP 3

Raise mast into vertical position using lower winch.

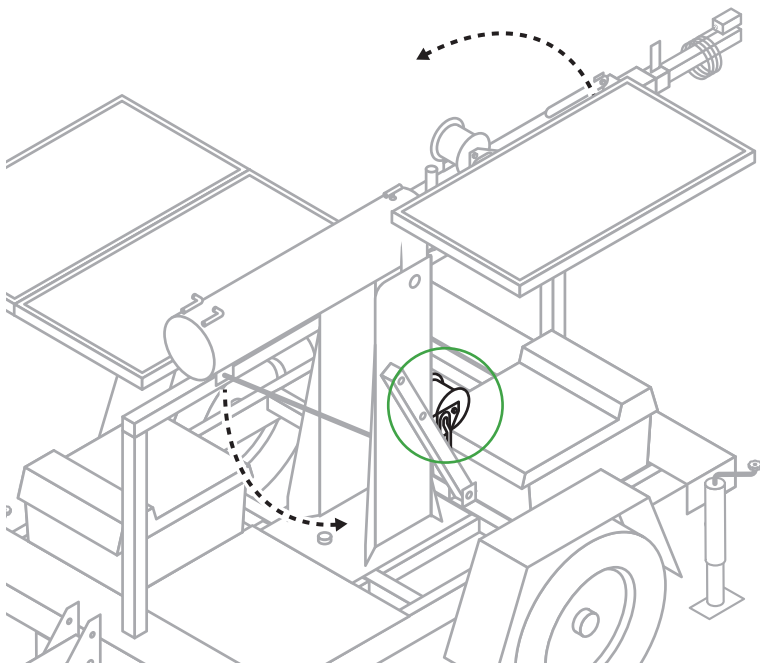

STEP 4

Secure mast by pushing two locking pins into holes on base of mast. Mast must be fully upright for pin holes to align.

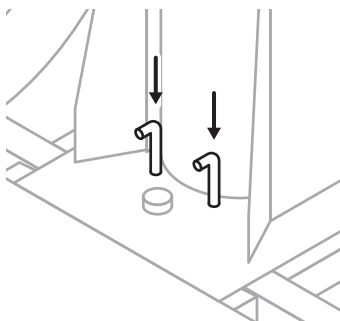

FINAL SETUP

STEP 5

Raise mast until desired height is reached using higher winch. Maximum mast height is 30 feet.

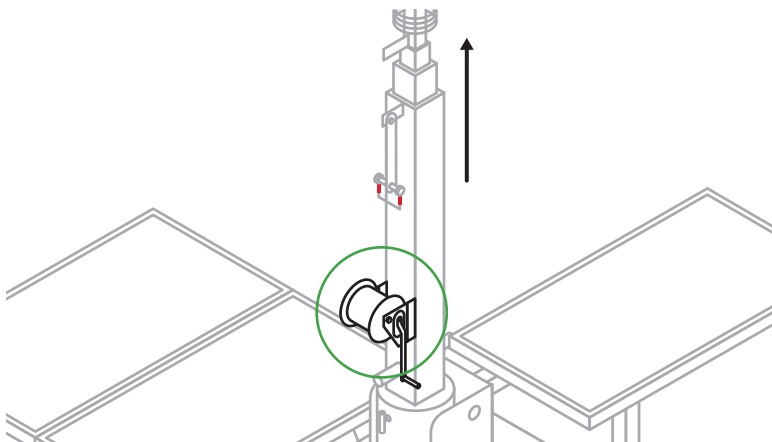

STEP 6

Fully loosen rotation lock bolt and rotate mast to desired position. Once position is achieved, re-tighten locking bolt.

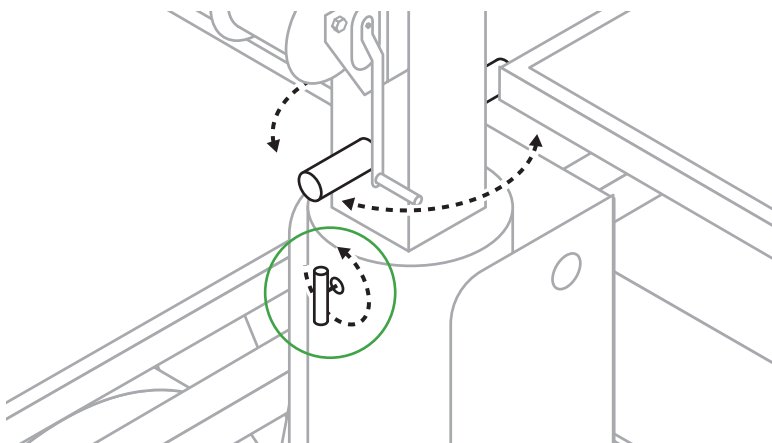

Solar Panel Positioning



FAILURE TO OBSERVE ALL FOLLOWING REQUIREMENTS MAY RESULT IN SYSTEM DOWNTIME. UNITS SELF-RECOVER AUTOMATICALLY ONCE PANEL RECEIVES SUFFICIENT SUNLIGHT.

STEP 1

Face panels due south.

Solar panels must face the equator (directly south) in order to capture adequate sunlight and properly charge.

To position them, pull down on panel swivel lock bolt and move panels to face south. Then, replace lock bolt to secure.

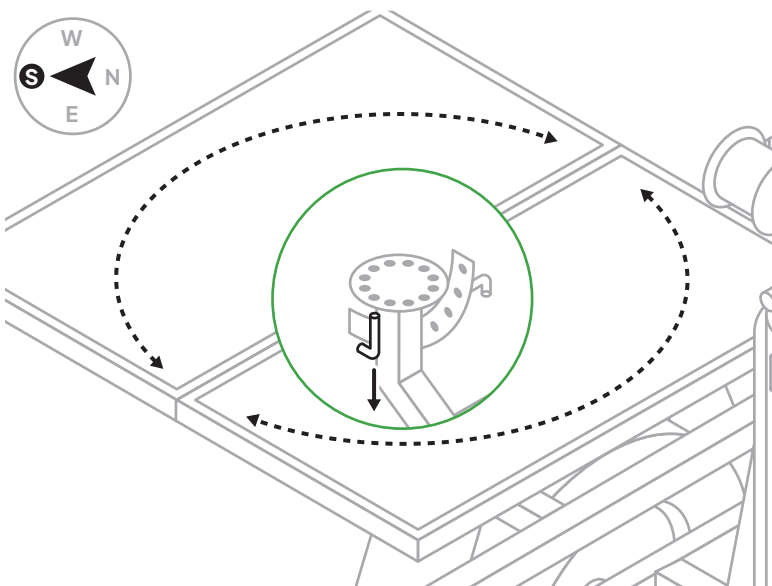

FINAL SETUP

STEP 2

Angle panels for your location.

Adjust the angle of your solar panels by removing panel angle adjuster bolt and placing it in corresponding hole.

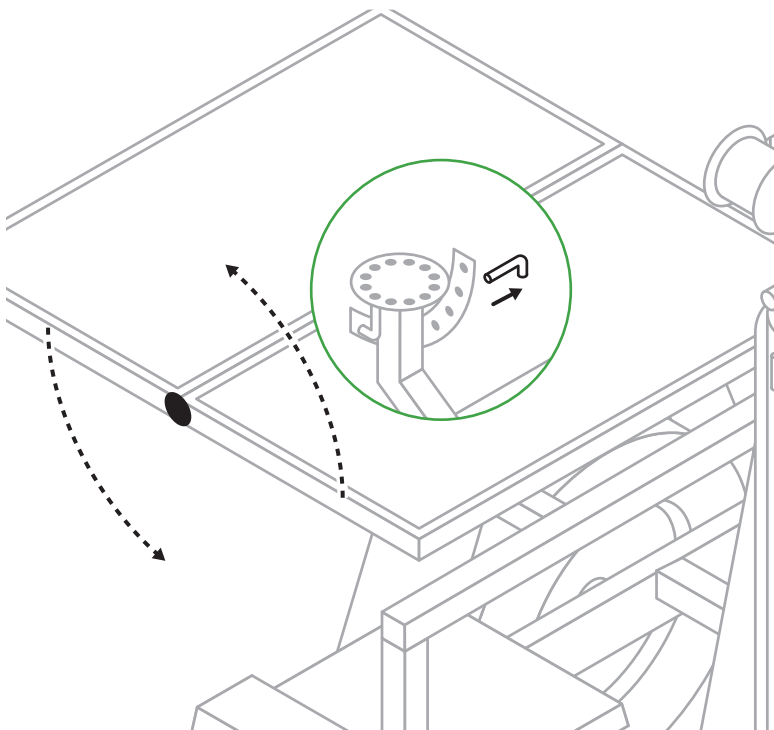

Refer to the chart on the following page to determine the proper angle based on your state.

FINAL SETUP

Alabama	45°	Montana	70°
Alaska	80°	Nebraska	65°
Arizona	45°	Nevada	65°
Arkansas	60°	New Hampshire	65°
California	45°	New Jersey	65°
Colorado	55°	New Mexico	45°
Connecticut	60°	New York	65°
Delaware	65°	North Carolina	60°
District of Col.	60°	North Dakota	70°
Florida	45°	Ohio	60°
Georgia	55°	Oklahoma	50°
Hawaii	40°	Oregon	65°
Idaho	65°	Pennsylvania	65°
Illinois	65°	Rhode Island	65°
Indiana	65°	South Carolina	55°
Iowa	65°	South Dakota	65°
Kansas	65°	Tennessee	60°
Kentucky	60°	Texas	45°
Louisiana	45°	Utah	65°
Maine	65°	Vermont	65°
Maryland	60°	Virginia	60°
Massachusetts	65°	Washington	65°
Michigan	65°	West Virginia	60°
Minnesota	65°	Wisconsin	65°
Mississippi	45°	Wyoming	65°
Missouri	60°		

FINAL SETUP

STEP 3

Ensure panels remain unobstructed.

Panels must receive direct sunlight throughout the day. Do not let trees, equipment, structures, or anything else block the sun.

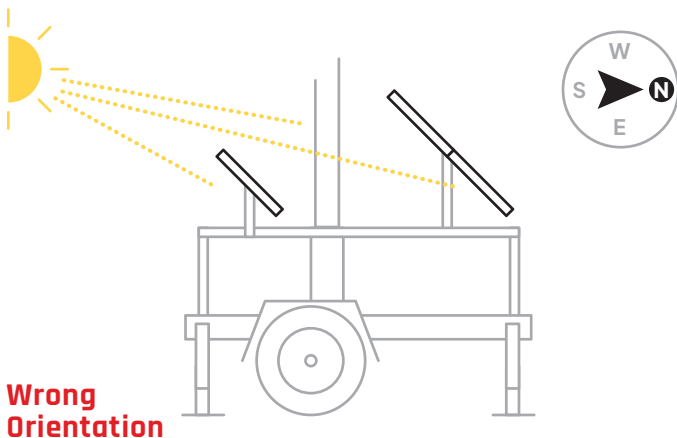
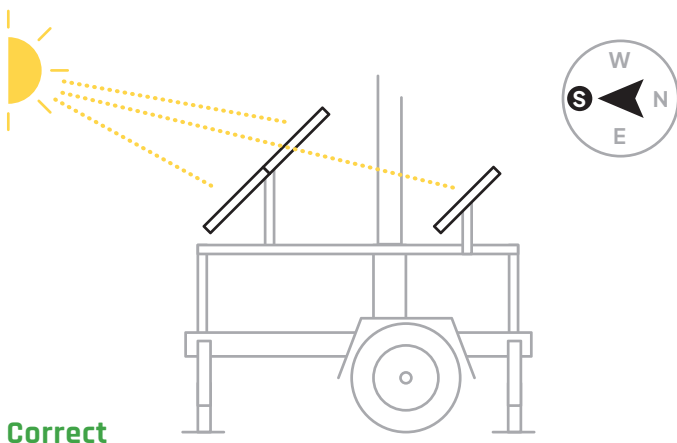

Trailer Maintenance Tips



Do not allow smoking or open flames near battery compartment.



Regularly check that tire pressure is 45 psi (310 kPa).



Clean camera lens as needed using a microfiber cloth.



The solar panels are designed to quickly melt snow on their own.

If there is a more urgent need to remove snow, gently use a soft brush. Using too much force may scratch or damage the panels.

Mast Stabilization

Due to a variety of factors (local weather conditions, camera weight, etc.), you may notice the trailer mast swaying. If you experience this, please follow these steps to increase your mast's stability.

STEP 1

Lower the mast and locate the six rollers on the trailer.

There are two sets of three; one set in the middle section of the extendable mast and one set near the top of the extendable mast.

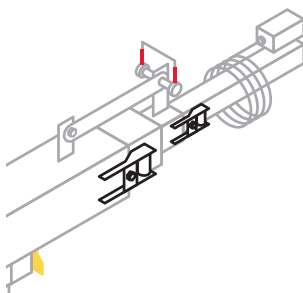

STEP 2

Tighten each roller using a T25 Allen wrench (not included) by inserting the wrench into the keyhole below each roller and turning clockwise one revolution.

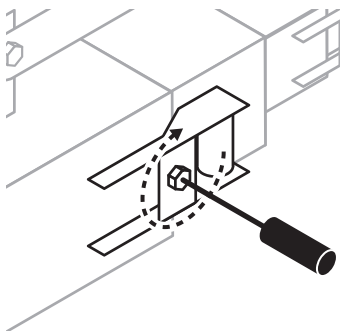

STEP 3

Repeat with all remaining keyholes.

One Last Step!

Did you know that our support team offers a free installation review?

Once you're done, simply snap a few pictures and email them to support@truelook.com. If we notice anything that we can help with, we'll reach out. This will also help our support team quickly view your setup if you run into equipment issues at any point in the future.

THE EMAIL

For the most efficient response from our team, include the following in your email:

- 1 Company Name
- 2 Project Name
- 3 Contact person for installation issues
- 4 The following photographs:
 - a) Your whole TrueLook solution: the camera, what it's mounted to, and any accessories
 - b) Close-ups of mounting
 - c) Close-ups of connections
 - d) Inside control box, if applicable

Your Unique Login