

Mobile Camera Trailer Manual

18 Foot Mast



24/7 Support

Your purchase of this TrueLook system includes customer and technical support. If you have any questions regarding the use or configuration of this equipment and software, please don't hesitate to contact us.

Phone 833.878.3566

Email support@truelook.com

Office 575 4th Street E, Winston Salem, NC 27101

Online Resources

Use this QR code or visit www.truelook.com/install to access:

- 1 An admin guide to walk you through creating your time-lapses and other administrative settings.
- 2 Video demonstrations of installation procedures.
- 3 A digital PDF of this install guide.
- 4 Download links for the TrueLook mobile app.
- 5 Other help resources.

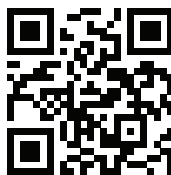

Mobile Trailer Parts

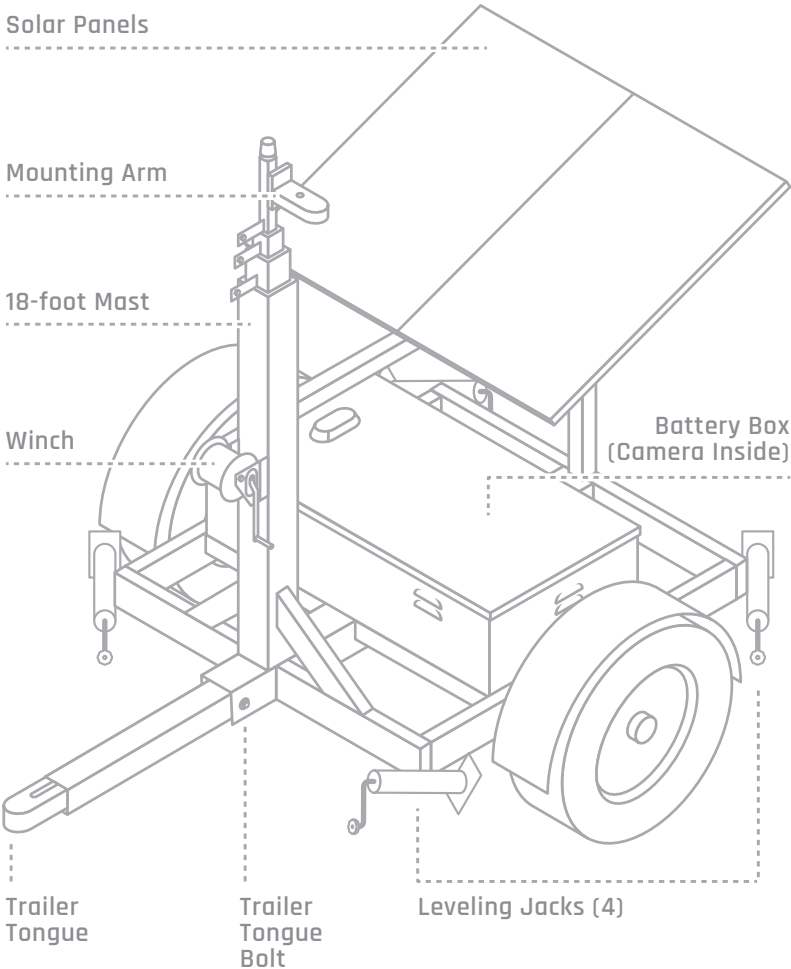

Positioning Mobile Camera Trailer



Place your camera trailer **20-150 feet away.**

For optimal viewing, place your trailer 20-150 feet away from the areas of your jobsite that you wish to capture. The distance you choose will depend on the camera you've selected (PTZ or fixed-position), the size of your jobsite, and the amount of detail you want to capture.

Contact your **TrueLook Account Executive** with any questions.



For PTZ cameras, choose the best **mast location.**

PTZ cameras have 360-degree views but the trailer's mast will cause a small blind spot. Orient your trailer so that the mast doesn't block important areas of your jobsite from view.

Positioning Mobile Camera Trailer



FAILURE TO OBSERVE ALL FOLLOWING REQUIREMENTS
MAY RESULT IN SYSTEM DOWNTIME. UNITS SELF-RECOVER
AUTOMATICALLY ONCE PANEL RECEIVES SUFFICIENT SUNLIGHT.



Face panels **due south.**

Position solar panels to face the equator (**due south**) in order to capture adequate sunlight.



Ensure panels remain **unobstructed.**

Panels must receive direct sunlight all day. Do not let trees, dirt, structures, or anything else block the sun - at any time of day.

Review **Solar Panel Positioning Chart** (following page) for correct and incorrect panel placements.

Solar Panel Position Chart

Once onsite, position the trailer so that the panels are **FACING SOUTH**.

The solar panels **MUST FACE DIRECTLY SOUTH** in order to properly charge. Ensure the solar panel **remains unobstructed** throughout the day. Failure to do so may result in loss of battery power.

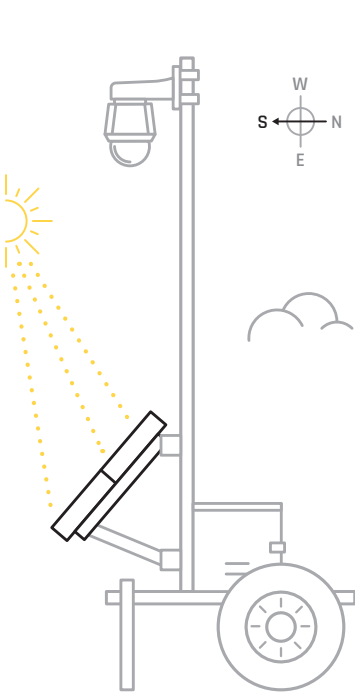

CORRECT

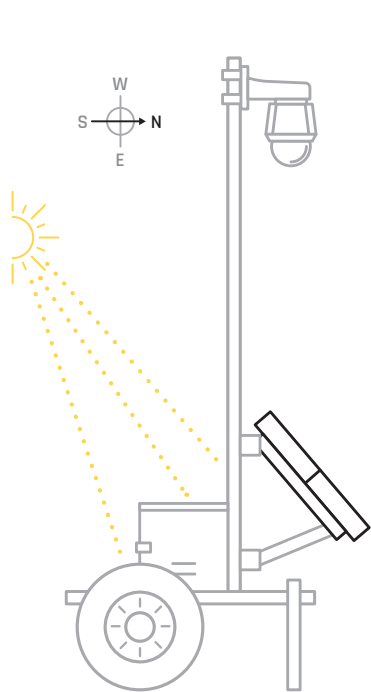

WRONG ORIENTATION

Stabilizing the Trailer

STEP 01

Once the trailer is placed in an optimal position (refer to previous pages), rotate and lower the jacks on each corner of the trailer.

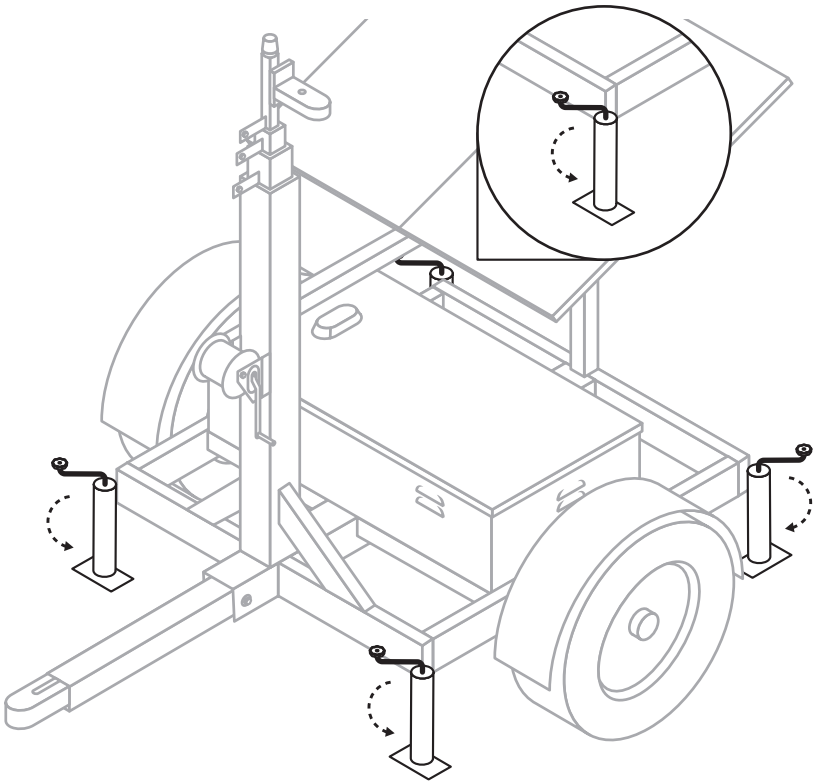

Stabilizing the Trailer

STEP 02

Turn the handles on each jack until the wheels are lifted slightly off the ground and the trailer is level.

You can then unhitch the trailer from the vehicle used to transport it.

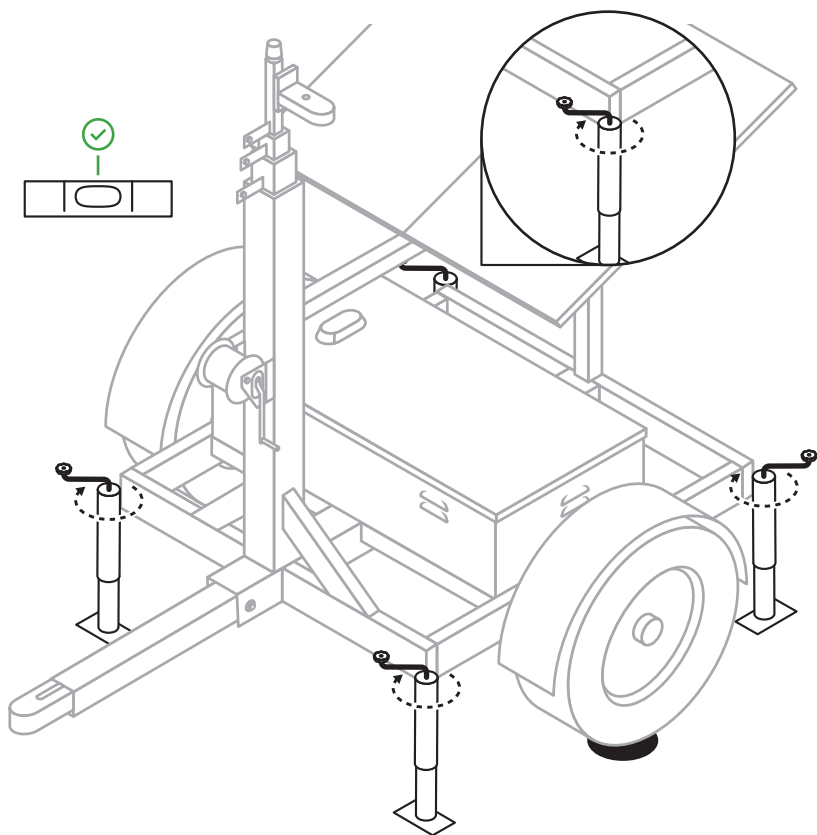

Camera Installation:

PTZ Camera

STEP 01

Loosen the captive screw at the top cover of the camera mount and lift the top off.

Set cover aside for later.

Tools
Required

T30 Torx
Driver

Ladder
(Optional)

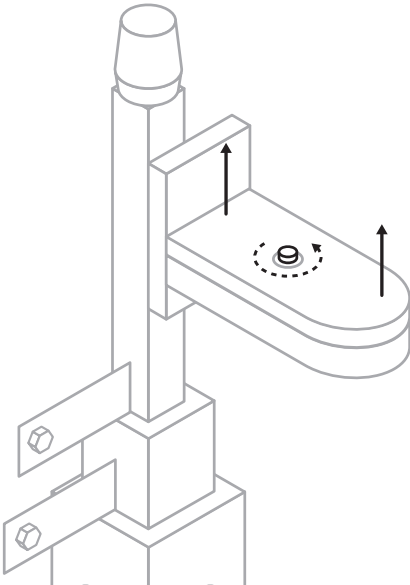

INSTALLATION

STEP 02

Insert the top of the camera into the pre-attached camera mount by lining up the openings for the screws. Then, turn it until it stays in place.

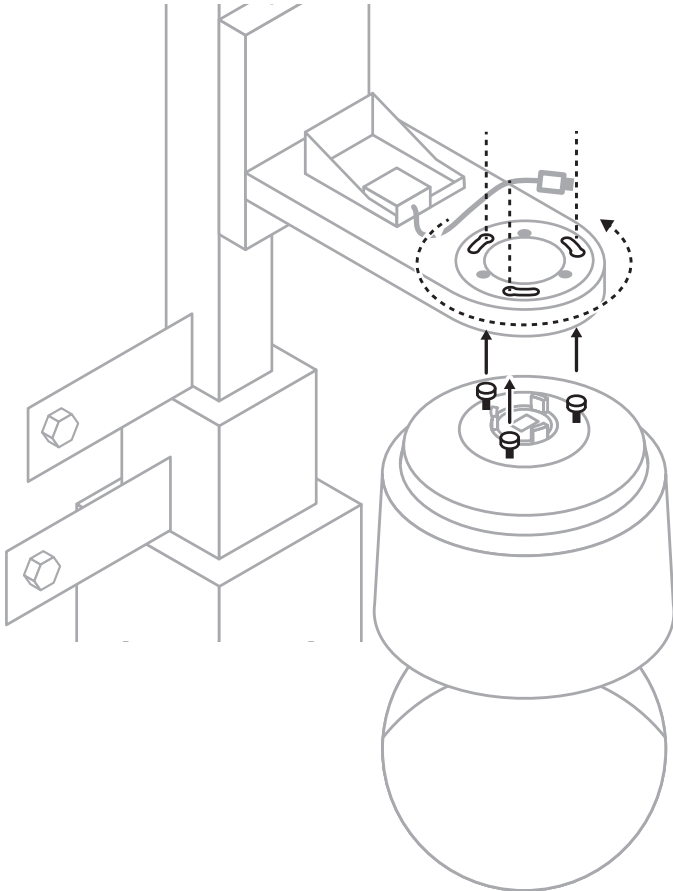

INSTALLATION

STEP 03

Support the camera while you tighten the three screws.

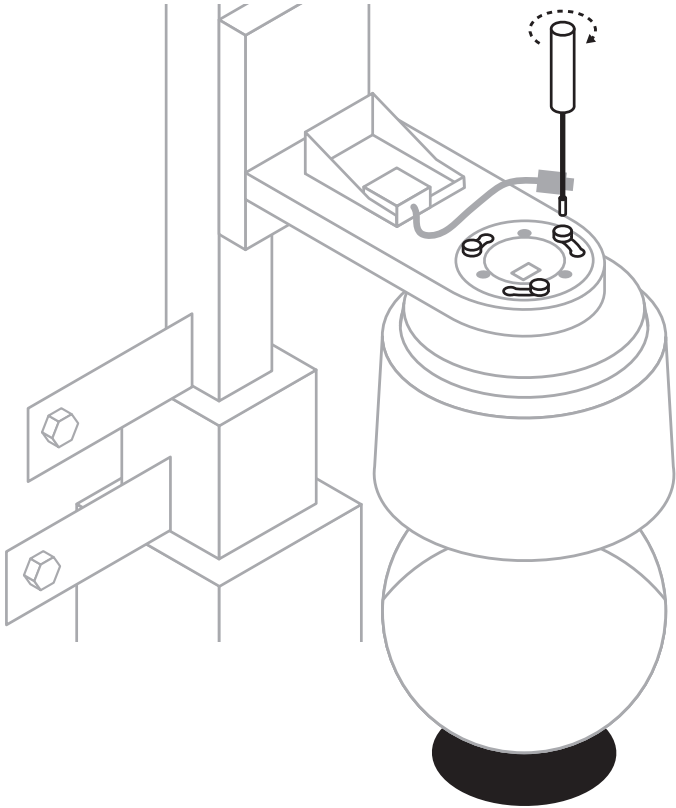

INSTALLATION

STEP 04

Plug the cable into the top of the camera. Reattach the top cover of the mount and tighten the captive screw.

Once powered, your camera should come online automatically within 10 minutes.

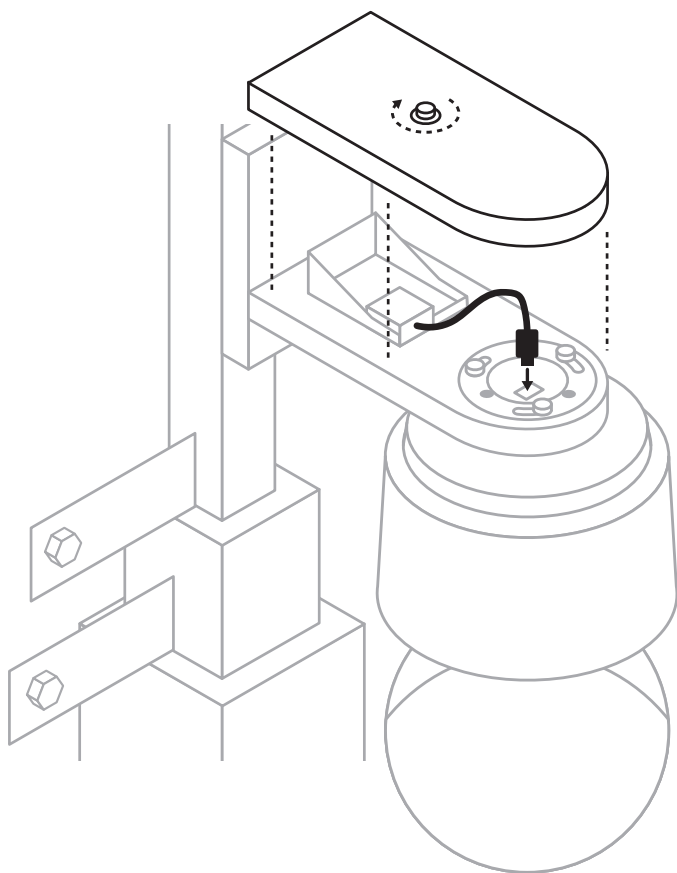

Camera Installation: Fixed 4K IR JSS Camera

STEP 01

Feed the two provided pole mounting straps through the openings on each side of the camera base.

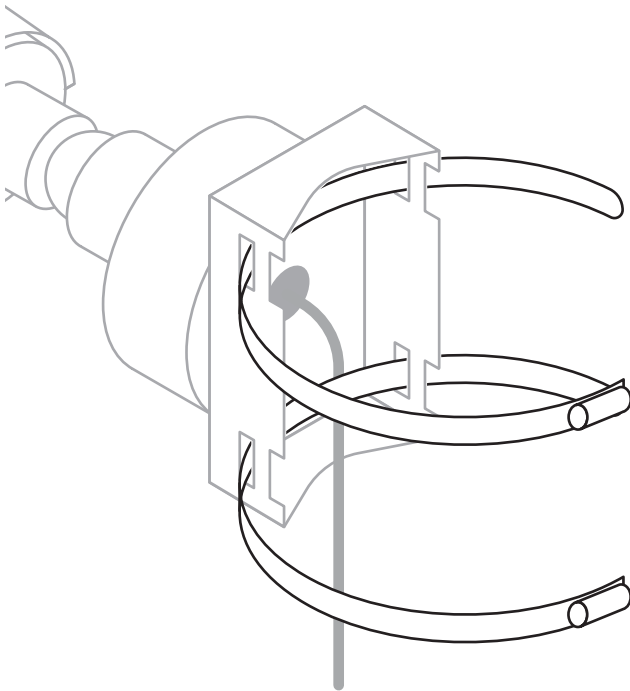

INSTALLATION

STEP 02

Secure each pole mounting strap near the top of the trailer mast.

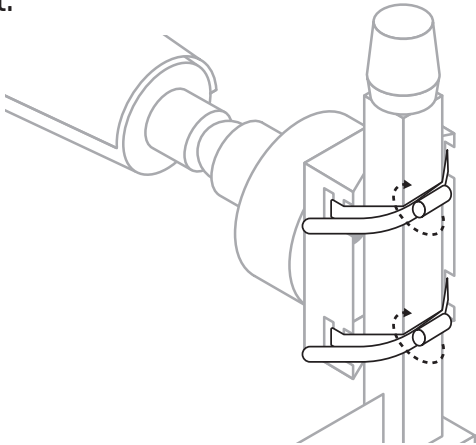

STEP 03

Plug camera cord into ethernet cable on trailer.

Use your hands to tighten the weather-protection coupler around the connection.

Once powered, your camera should come online automatically within 10 minutes.

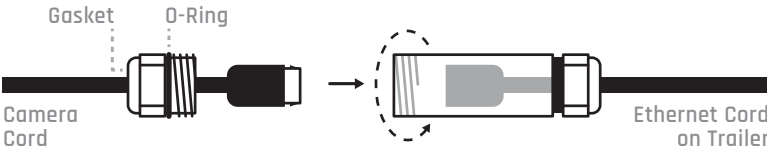

PLEASE ENSURE GASKET AND O-RING ARE IN PROPER PLACE. NEVER USE TOOLS TO TIGHTEN COUPLER. THIS MAY RESULT IN OVERTIGHTENING AND COULD BREAK THE ETHERNET CORD OR THE COUPLER ENTIRELY.

Camera Installation: Fixed 4K IR Camera

STEP 01

Align the camera arm with the base that has been pre-attached to the trailer.

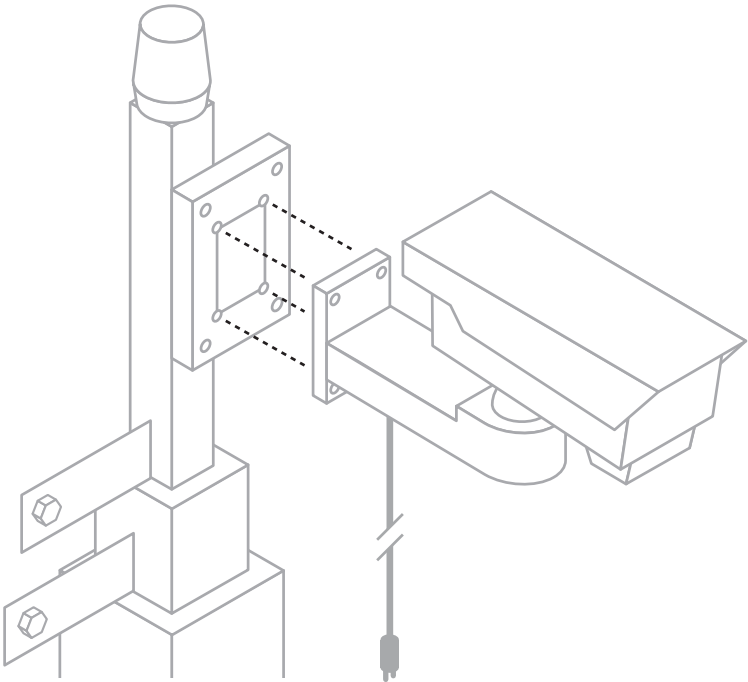

INSTALLATION

STEP 02

Install four screws to attach the arm to the base.

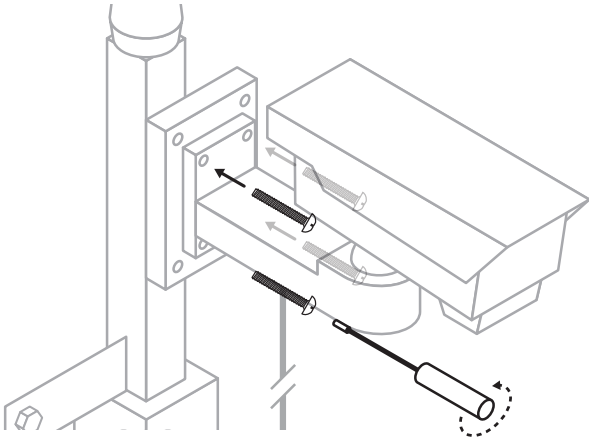

STEP 03

Plug camera cord into ethernet cable on trailer.

Use your hands to tighten the weather-protection coupler around the connection.

Once powered, your camera should come online automatically within 10 minutes.

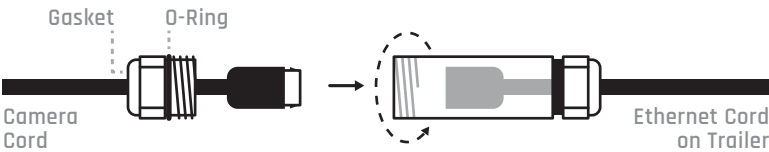

PLEASE ENSURE GASKET AND O-RING ARE IN PROPER PLACE. NEVER USE TOOLS TO TIGHTEN COUPLER. THIS MAY RESULT IN OVERTIGHTENING AND COULD BREAK THE ETHERNET CORD OR THE COUPLER ENTIRELY.

Raising the Mast

Gently pull the ethernet cord out from the battery box (A).

It will be a cord sticking out of the bottom of the battery box, leading up to the camera.

Turn the handle on the mast (B) while ensuring the ethernet cord remains slack so it doesn't get caught.

The mast is fully extended when the handle stops turning.

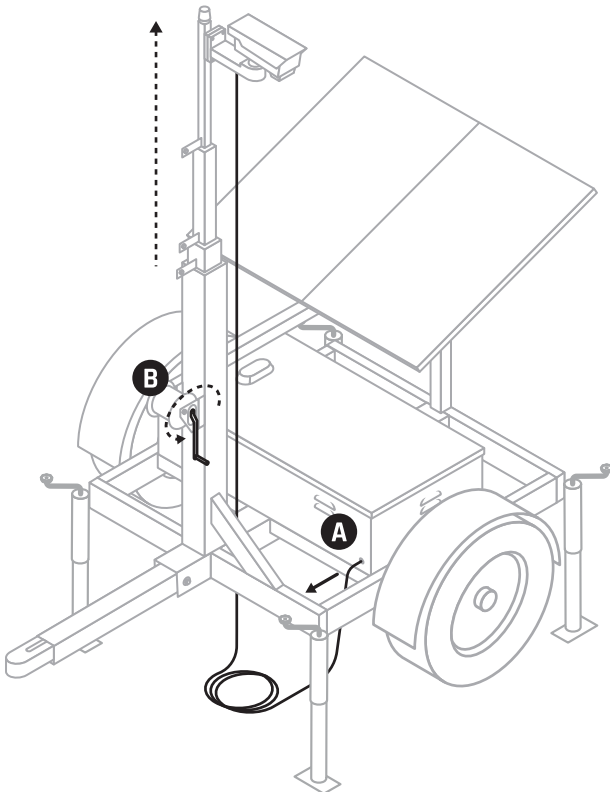

Securing the Trailer



THE FOLLOWING STEPS ARE OPTIONAL BUT ARE RECOMMENDED TO AVOID TAMPERING AND THEFT.

A

Lock the winch to prevent the mast from being lowered.



B

B

Lock the battery box to protect its contents.

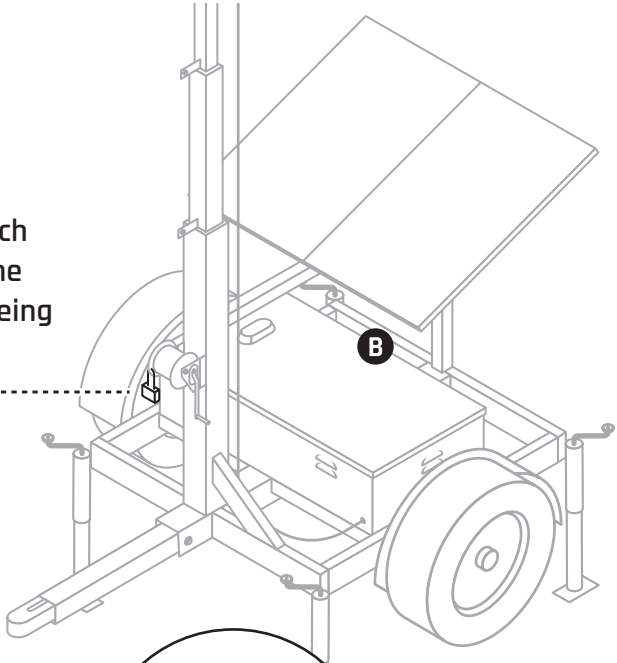
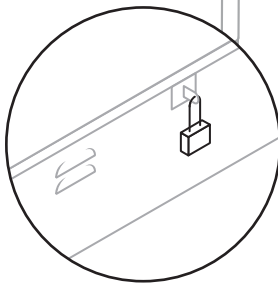

Securing the Trailer



THE FOLLOWING STEPS ARE OPTIONAL BUT ARE RECOMMENDED TO AVOID TAMPERING AND THEFT.

C

Lock or remove the trailer tongue/hitch.

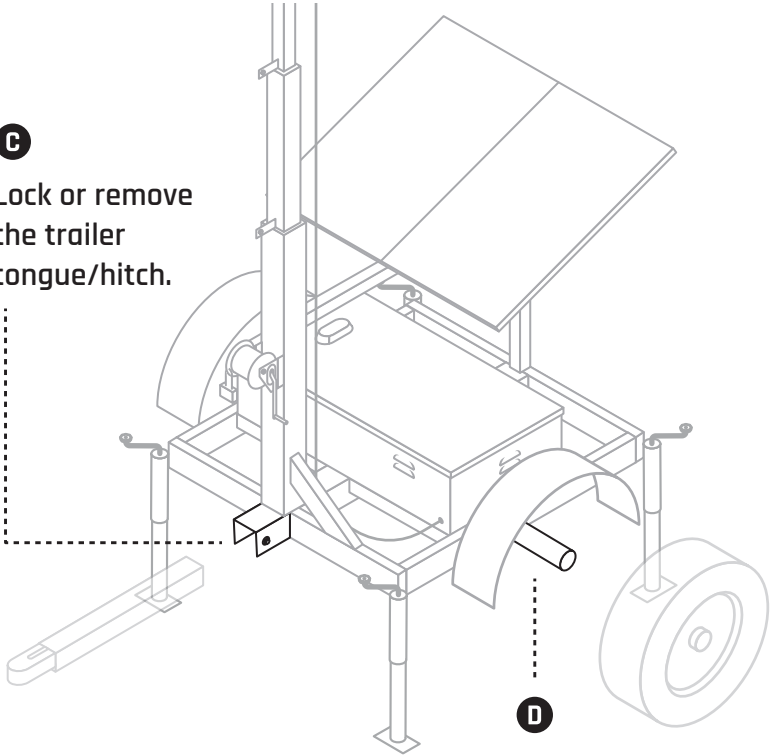

D

Lock or remove the trailer wheels.

Terms and Conditions

Customer is responsible for installation of all Products. It is Customer's responsibility to install Products in accordance with all applicable laws, codes, rules, regulations, requirements and safety standards. Notwithstanding the foregoing, upon request by Customer, TrueLook may provide installation assistance, either itself or through a contractor, on mutually agreeable terms. For full terms and conditions visit: www.truelook.com/terms-conditions/

Warranty

If you purchase a TrueLook SAAS subscription along with your new webcam, TrueLook will provide continuing warranty coverage for such webcam after expiration of the Manufacturer's Warranty subject to the same terms and limits set forth in the Manufacturer's Warranty up to replacement of a defective webcam so long as you remain continuously subscribed to the TrueLook SAAS that you purchased with such new webcam (the "TrueLook Extended Warranty"); provided, that TrueLook's maximum liability under the TrueLook Extended Warranty shall be to exchange a defective webcam for a new webcam of the same or a comparable model. For avoidance of doubt, if such TrueLook SAAS subscription ends or lapses for any reason, the TrueLook Extended Warranty on such webcam shall expire and will not be reactivated if such TrueLook SAAS subscription is reinstated. For full warranty visit: www.truelook.com/terms-conditions/